



**FITTING INSTRUCTIONS FOR SP0057BK SWING-ARM
PROTECTORS**
BMW S1000RR 2010-14/ HP4
SUZUKI GSXR 1000 2005-,GSXR 750 2006-,GSXR 600 2006-
**ONLY TO BE USED ON MACHINES FITTED WITH SPINDLE MEASURING 16mm
AND 23.5mm LOCATION DIAMETERS**



**THIS KIT CONTAINS THE ITEMS PICTURED AND LABELLED BELOW.
DO NOT PROCEED UNTIL YOU ARE SURE ALL PARTS ARE PRESENT.**

Please note that the way the kit is packed does not necessarily represent the way of mounting to the bike

THE PARTS SHOWN MAY BE REPRESENTATIVE ONLY (FOR CLARITY OF INSTRUCTIONS ONLY)

Please note that in cases where kits are packed with rubber washers holding the components onto the bolt – *the rubber washers should be thrown away!*

TOOLS REQUIRED

- 4mm metric Allen key.

LEGEND

- ITEM 1 = B0481 CRASH PROTECTOR (2)
ITEM 2 = M0354 EXPANDER (LHS)
ITEM 3 = M0385 EXPANDER (RHS)
ITEM 4 = M6 X 1.00 X 40mm CSK BOLT (LHS)
ITEM 5 = M6 X 1.00 X 65mm CSK BOLT (RHS)
ITEM 6 = H0015 M6 EXPANDER NUT (2)

R&G Racing
Unit 1, Shelleys Lane, East Worldham, Alton, Hampshire, GU34 3AQ
Tel: +44 (0) 1420 89007 | Fax : +44 (0) 1420 87301 | Email: info@rg-racing.com

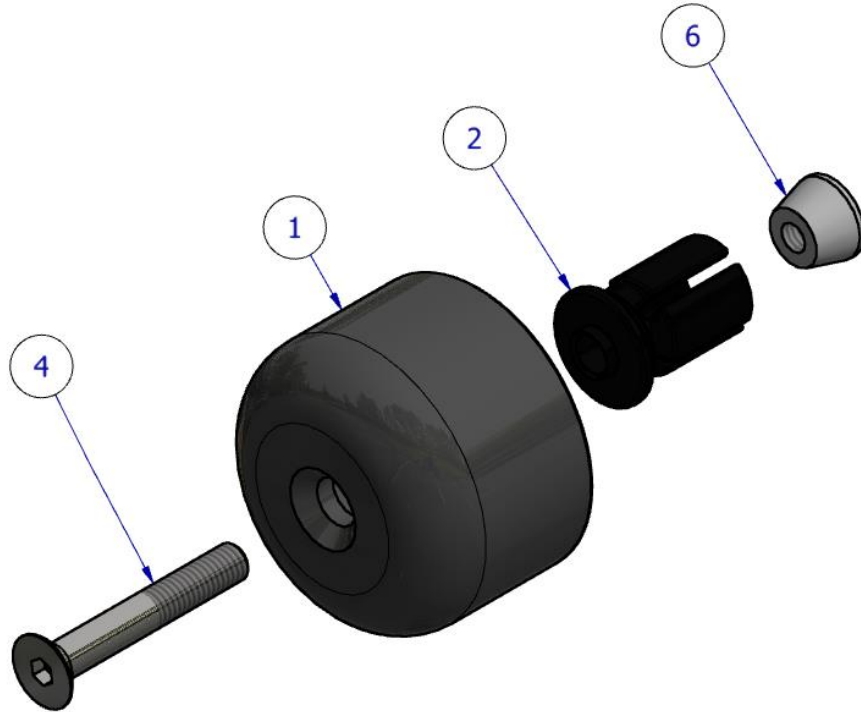

LEFT HAND SIDE

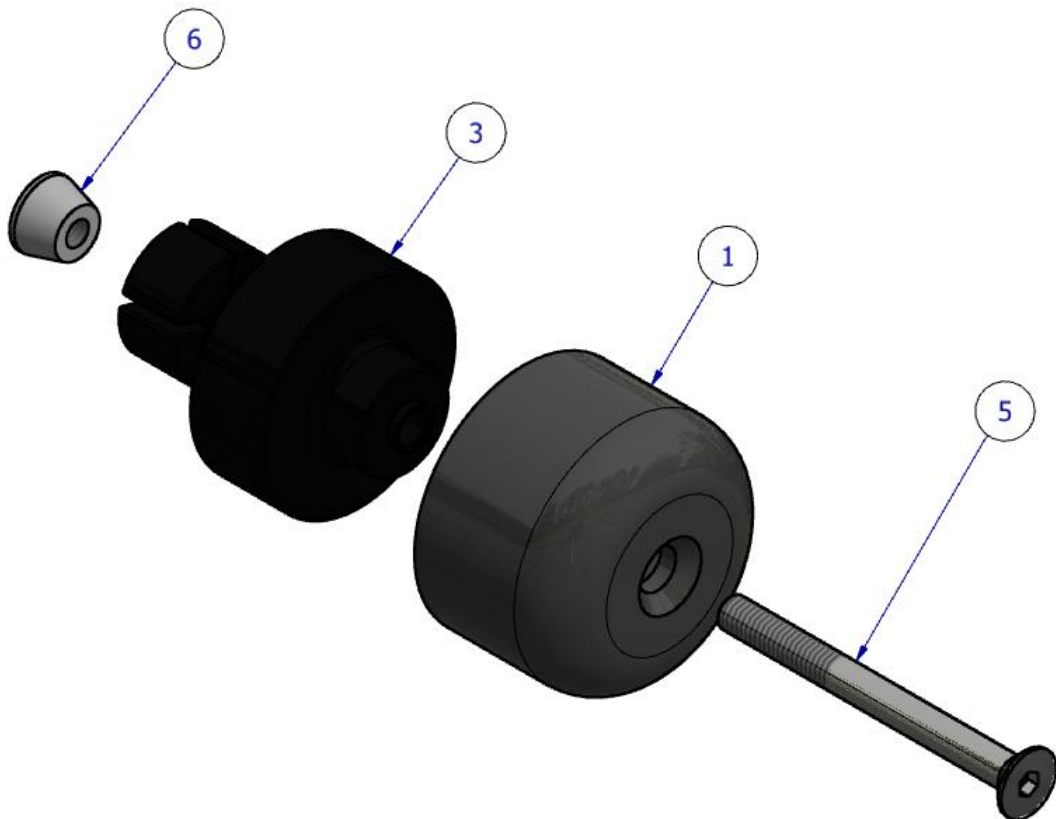

RIGHT HAND SIDE



Left-hand side (as you sit on bike)

- Fit the shorter counter sunk bolt (item 4) through the crash protector so head sits in counter-sink.
- Place one crash protector (item 1) on to the smaller mounting block (item 2).
- Place special nut (item 6) on exposed end of bolt so tapered face goes into recess of the mounting block.
- Tighten bolt until tapered portion of nut just contacts in the recessed face of the mounting block.
- Place this assembly into the left-hand side of the rear wheel spindle.
- Tighten the bolt so crash protector is held in position firmly (do not over tighten).
- **Regularly check to ensure crash protector remains tight.**

Right-hand side (as you sit on bike)

- Fit the longer counter sunk bolt (item 5) through the crash protector so head sits in counter-sink.
- Place the crash protector (item 1) on to the larger mounting block (item 3).
- Place special nut (item 6) on exposed end of bolt so tapered face goes into recess of the mounting block.
- Tighten bolt until tapered portion of nut just contacts in the recessed face of the mounting block.
- Place this assembly into the right-hand side of the rear wheel spindle.
- Tighten the bolt so crash protector is held in position firmly (do not over tighten).
- **Regularly check to ensure crash protector remains tight.**

Issue 2 26/03/2019 (DM)

CONSUMER NOTICE

The catalogue description and any exhibition of samples are only broad indications of the Products and R&G may make design changes which do not diminish their performance or visual appeal and supplying them in such state shall conform to the order. The Buyer acknowledges no representation or warranty (other than as to title) has been given or will apply to the Products other than those in R&G's order or confirmation and the Buyer confirms it has chosen the Products as being of merchantable quality and suitable for its particular purposes. Where R&G fits the Products or undertakes other services it shall exercise reasonable skill and care and rectify any fault free of charge unless the workmanship has been disturbed. The Buyer is responsible for ensuring that the warranty on the motorcycle is not affected by the fitting of the Products. On return of any defective Products R&G shall at its option either supply a replacement or refund the purchase money but shall not be liable if the Products have been modified or used or maintained otherwise than in accordance with R&G's or manufacturer's instructions and good engineering practice or if the defect arises from accident or neglect. Other than identified above and subject to R&G not limiting its liability for causing death and personal injury, it shall not be liable for indirect or consequential loss and otherwise its liability shall be limited to the amounts paid by the Buyer for the Products or the fitting or service concerned. These terms do not affect the Buyer's statutory rights.

R&G RACING RETURNS POLICY (NON-FAULTY GOODS)

Returns must be pre-authorised (if not pre-authorised the return will be rejected). Goods may only be returned direct to us if they were purchased direct from us (customer must prove if necessary). Otherwise to be returned to original vendor. Goods must be in re-sellable condition, in the opinion of R&G Racing. All returns are subject to a 25% restocking and handling fee (25% of the gross value exc. P&P – at the prevailing price at time of purchase). The customer must pay any and all carriage charges. No returns of discontinued products, unless within 14 days of purchase. This policy does not affect your statutory rights and does not refer to faulty goods.



**NOTICE DE MONTAGE POUR SP0057BK PROTECTIONS BRAS
OSCILLANT
BMW S1000RR 2010-14/ HP4
SUZUKI GSXR 1000 2005-, GSXR 750 2006-, GSXR 600 2006-**
**UNIQUEMENT POUR LES MACHINES ÉQUIPÉES D'UN MOYEU MESURANT 16mm
ET D'UN DIAMÈTRE D'EMPLACEMENT DE 23.5mm.**



**LE KIT CONTIENT LES ARTICLES EXPOSÉS CI-DESSOUS, VÉRIFIER QUE TOUTES
LES PIÈCES SOIENT PRÉSENTES AVANT DE PROCÉDER AU MONTAGE.**

**LA FAÇON DONT LE KIT EST EMBALLÉ NE CORRESPOND PAS FORCÉMENT À LA
FAÇON DE MONTER LES PIÈCES SUR LA MOTO.**

LES PARTIES PRÉSENTÉES PEUVENT ÊTRE UNIQUEMENT REPRÉSENTATIVES (POUR LA
CLARTÉ DES INSTRUCTIONS UNIQUEMENT).

Notez que si les kits sont emballés avec des rondelles en caoutchouc servant à tenir les
composants, *ces rondelles doivent être jetées !*

OUTILS REQUIS

- Clé Allen 4mm.

LÉGENDE

ARTICLE 1 = B0481 PROTECTION CRASH (2)

ARTICLE 2 = M0354 ÉCARTEUR (GAUCHE)

ARTICLE 3 = M0385 ÉCARTEUR (DROITE)

ARTICLE 4 = M6 X 1.00 X 40mm BOULON CSK (GAUCHE)

ARTICLE 5 = M6 X 1.00 X 65mm BOULON CSK (DROITE)

R&G Racing

Unit 1, Shelleys Lane, East Worldham, Alton, Hampshire, GU34 3AQ

Tel: +44 (0) 1420 89007 | Fax : +44 (0) 1420 87301 | Email: info@rg-racing.com



ARTICLE 6 = H0015 M6 ÉCROU D'ÉCARTEUR (2)

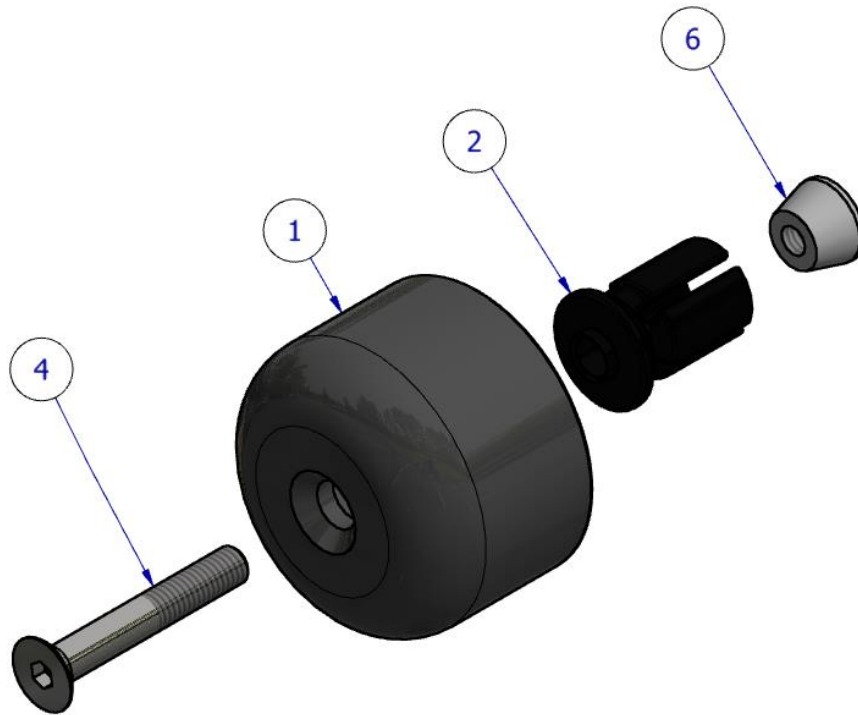

CÔTÉ GAUCHE

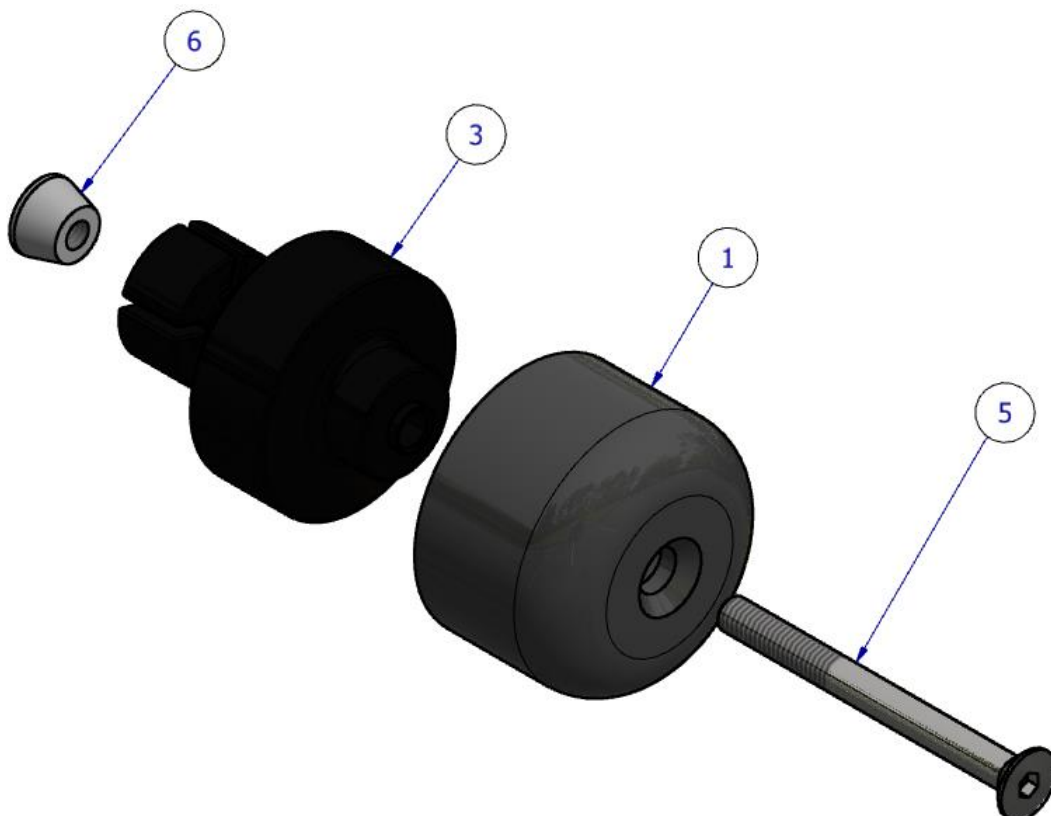



CÔTÉ DROIT

Côté gauche (assis sur la moto)

- Serrer le boulon court (article 4) dans la protection crash, de façon à ce que la tête se place dans le contre alésage.
- Placer une protection crash (article 1) sur le petit bloc de fixation (article 2).
- Placer l'écrou spécial (article 6) sur l'extrémité du boulon de façon à ce que la face conique se place dans le creux du bloc de montage.
- Serrer le boulon jusqu'à ce que la portion conique de l'écrou touche le creux du bloc de montage.
- Placer cet ensemble du côté gauche du moyeu de roue arrière.
- Serrer le boulon de façon à ce que la protection crash soit fixée en position (ne pas trop bloquer).
- **Vérifier le serrage de la protection régulièrement.**

Côté droit (assis sur la moto)

- Serrer le boulon court (article 5) dans la protection crash, de façon à ce que la tête se place dans le contre alésage.
- Placer une protection crash (article 1) sur le gros bloc de fixation (article 3).
- Placer l'écrou spécial (article 6) sur l'extrémité du boulon de façon à ce que la face conique se place dans le creux du bloc de montage
- Serrer le boulon jusqu'à ce que la portion conique de l'écrou touche le creux du bloc de montage.
- Placer cet ensemble du côté droit du moyeu de roue arrière.
- Serrer le boulon de façon à ce que la protection crash soit fixée en position (ne pas trop bloquer).
- **Vérifier le serrage de la protection régulièrement.**

Issue 2 26/03/2019 (DM)

CONSUMER NOTICE

The catalogue description and any exhibition of samples are only broad indications of the Products and R&G may make design changes which do not diminish their performance or visual appeal and supplying them in such state shall conform to the order. The Buyer acknowledges no representation or warranty (other than as to title) has been given or will apply to the Products other than those in R&G's order or confirmation and the Buyer confirms it has chosen the Products as being of merchantable quality and suitable for its particular purposes. Where R&G fits the Products or undertakes other services it shall exercise reasonable skill and care and rectify any fault free of charge unless the workmanship has been disturbed. The Buyer is responsible for ensuring that the warranty on the motorcycle is not affected by the fitting of the Products. On return of any defective Products R&G shall at its option either supply a replacement or refund the purchase money but shall not be liable if the Products have been modified or used or maintained otherwise than in accordance with R&G's or manufacturer's instructions and good engineering practice or if the defect arises from accident or neglect. Other than identified above and subject to R&G not limiting its liability for causing death and personal injury, it shall not be liable for indirect or consequential loss and otherwise its liability shall be limited to the amounts paid by the Buyer for the Products or the fitting or service concerned. These terms do not affect the Buyer's statutory rights.

R&G RACING RETURNS POLICY (NON-FAULTY GOODS)

Returns must be pre-authorized (if not pre-authorized the return will be rejected). Goods may only be returned direct to us if they were purchased direct from us (customer must prove if necessary). Otherwise to be returned to original vendor. Goods must be in re-sellable condition, in the opinion of R&G Racing. All returns are subject to a 25% restocking and handling fee (25% of the gross value exc. P&P – at the prevailing price at time of purchase). The customer must pay any and all carriage charges. No returns of discontinued products, unless within 14 days of purchase. This policy does not affect your statutory rights and does not refer to faulty goods.



MONTAGEANLEITUNG FÜR SP0057BK SCHWINGENPROTEKTOREN

BMW S1000RR 2010-14/ HP4

SUZUKI GSXR 1000 2005-,GSXR 750 2006-,GSXR 600 2006-

**NUR FÜR DIE MONTAGE AN MOTORRÄDERN MIT EINER 16mm SPINDEL UND
23,5mm LAGE DURCHMESSER**



**ALLE TEILE SIND UNTEN ABGEBILDET UND GEKENNZEICHNET. ÜBERPRÜFEN SIE, DASS
ALLE TEILE VORHANDEN SIND; BEVOR SIE MIT DER MONTAGE BEGINNEN.**

Hinweis: Die Verpackung der Teile stellt nicht die Reihenfolge der Montage dar.

DIE UNTEN ABGEBILDETEN TEILE DIENEN LEDIGLICH ZUR ERKLÄRUNG

Hinweis für Kits mit Plastikunterlegscheiben an den Schrauben – *Diese
Plastikunterlegscheiben werden nicht für den Einbau benötigt!*

SIE BRAUCHEN FOLGENDES WERKZEUG

- 4mm Inbusschlüssel

LIEFERUMFANG

ARTIKEL 1 = B0481 STURZPAD (2)

ARTIKEL 2 = M0354 MONTAGEHALTERUNG (LINKE SEITE)

ARTIKEL 3 = M0385 MONTAGEHALTERUNG (RECHTE SEITE)

ARTIKEL 4 = M6 X 1.00 X 40mm SENKSCHRAUBE (LINKE SEITE)

ARTIKEL 5 = M6 X 1.00 X 65mm SENKSCHRUABE (RECHTE SEITE)

ARTIKEL 6 = H0015 M6 SPEZIAL MUTTER (2)

R&G Racing

Unit 1, Shelleys Lane, East Worldham, Alton, Hampshire, GU34 3AQ

Tel: +44 (0) 1420 89007 | Fax : +44 (0) 1420 87301 | Email: info@rg-racing.com

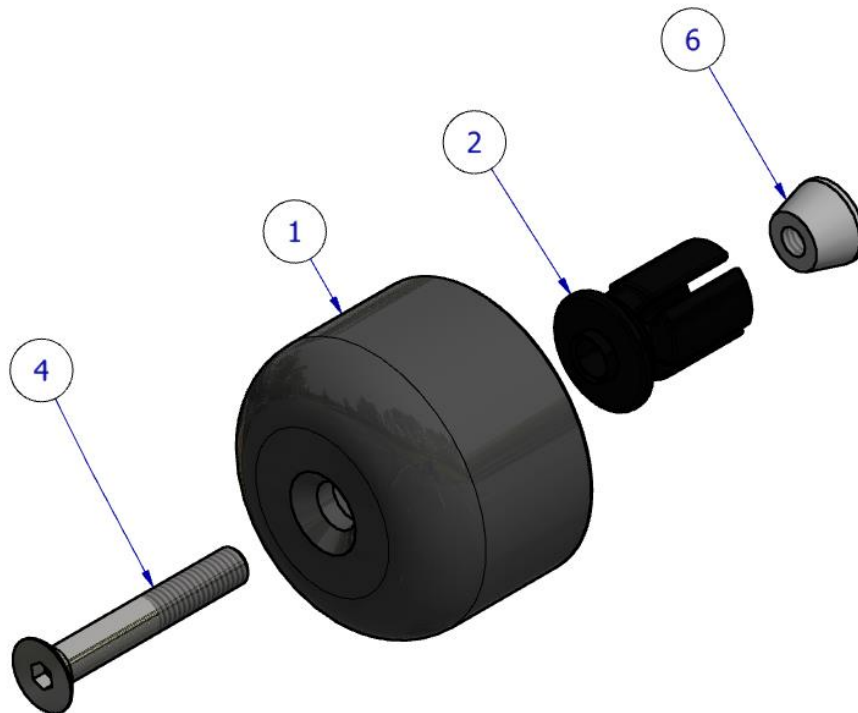

LINKE SEITE

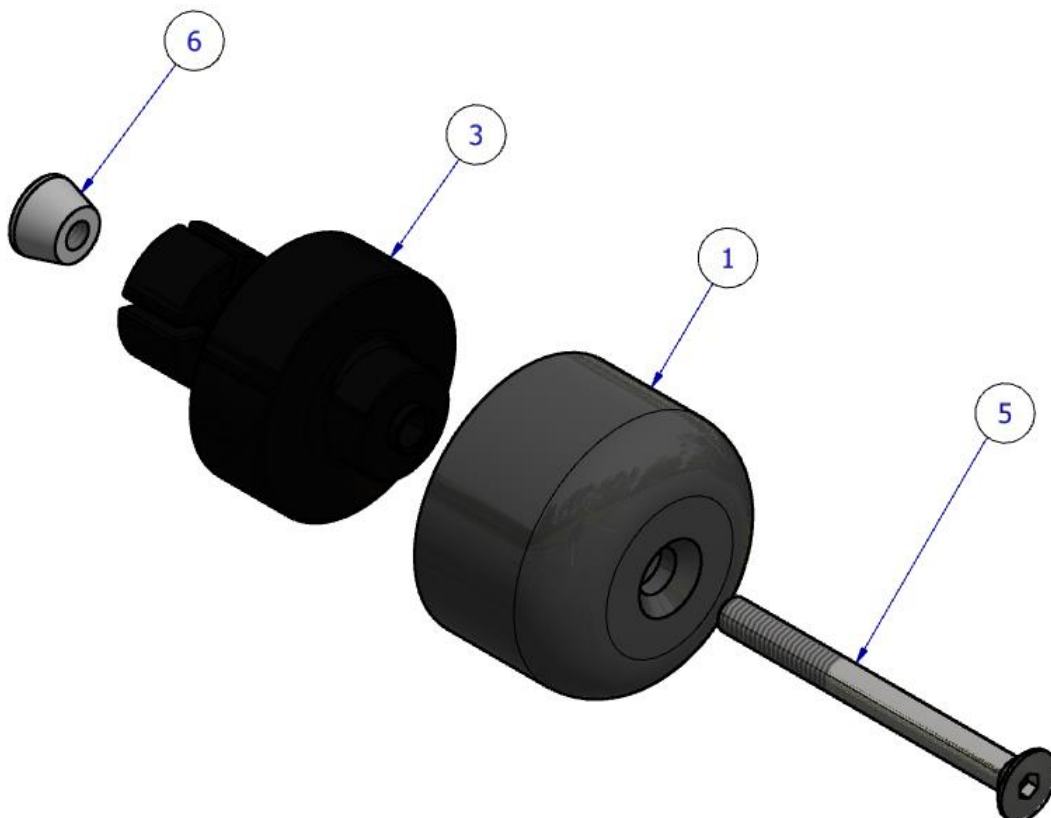

RECHTE SEITE



Linke Seite (in Fahrtrichtung)

- Führen Sie die kurze Senkschraube in ein Sturzpad ein, so dass der Schraubenkopf in der Senkbohrung sitzt.
- Ein Sturzpad (Artikel 1) an der kleineren Montagehalterung (Artikel 2) anbringen.
- Die Spezialmutter (Artikel 6) am hervorstehenden Schraubenende anbringen, sodass die gestufte Fläche in den Ausschnitt der Montagehalterung passt.
- Ziehen Sie die Schraube fest, bis die gestufte Fläche der Mutter die Ausschnittfläche der Montagehalterung berührt.
- Diese Einheit in die linke Seite der Hinterradachse einführen.
- Ziehen Sie die Schraube fest, um das Sturzpad in Position zu befestigen (nicht überdrehen).
- **Überprüfen Sie regelmäßig, dass der Schwingenprotector fest fixiert ist.**

Rechte Seite (in Fahrtrichtung)

- Führen Sie die längere Senkschraube (Artikel 5) in das übrige Sturzpad ein, so dass der Schraubenkopf in der Senkbohrung sitzt.
- Das Sturzpad (Artikel 1) an der großen Montagehalterung (Artikel 3) anbringen.
- Die Spezialmutter (Artikel 6) am hervorstehenden Schraubenende anbringen, sodass die gestufte Fläche in den Ausschnitt der Montagehalterung passt.
- Ziehen Sie die Schraube fest, bis die gestufte Fläche der Mutter die Ausschnittfläche der Montagehalterung berührt.
- Diese Einheit in die rechte Seite der Hinterradachse einführen.
- Ziehen Sie die Schraube fest, um das Sturzpad in Position zu befestigen (nicht überdrehen).
- **Überprüfen Sie regelmäßig, dass der Schwingenprotector fest fixiert ist.**

Ausgabe 2 26/03/2019 (DM)

CONSUMER NOTICE

The catalogue description and any exhibition of samples are only broad indications of the Products and R&G may make design changes which do not diminish their performance or visual appeal and supplying them in such state shall conform to the order. The Buyer acknowledges no representation or warranty (other than as to title) has been given or will apply to the Products other than those in R&G's order or confirmation and the Buyer confirms it has chosen the Products as being of merchantable quality and suitable for its particular purposes. Where R&G fits the Products or undertakes other services it shall exercise reasonable skill and care and rectify any fault free of charge unless the workmanship has been disturbed. The Buyer is responsible for ensuring that the warranty on the motorcycle is not affected by the fitting of the Products. On return of any defective Products R&G shall at its option either supply a replacement or refund the purchase money but shall not be liable if the Products have been modified or used or maintained otherwise than in accordance with R&G's or manufacturer's instructions and good engineering practice or if the defect arises from accident or neglect. Other than identified above and subject to R&G not limiting its liability for causing death and personal injury, it shall not be liable for indirect or consequential loss and otherwise its liability shall be limited to the amounts paid by the Buyer for the Products or the fitting or service concerned. These terms do not affect the Buyer's statutory rights.

R&G RACING RETURNS POLICY (NON-FAULTY GOODS)

Returns must be pre-authorized (if not pre-authorized the return will be rejected). Goods may only be returned direct to us if they were purchased direct from us (customer must prove if necessary). Otherwise to be returned to original vendor. Goods must be in re-sellable condition, in the opinion of R&G Racing. All returns are subject to a 25% restocking and handling fee (25% of the gross value exc. P&P – at the prevailing price at time of purchase). The customer must pay any and all carriage charges. No returns of discontinued products, unless within 14 days of purchase. This policy does not affect your statutory rights and does not refer to faulty goods.