



LP0330

FITTING INSTRUCTIONS FOR LP0330BK LICENCE PLATE BRACKET
YAMAHA R7 '22-



THIS KIT CONTAINS THE ITEMS PICTURED AND LABELLED OVER PAGE.

SOME PARTS MAY BE SHOWN FOR CLARITY OF INSTRUCTIONS ONLY.

DO NOT PROCEED UNTIL YOU ARE SURE ALL PARTS ARE PRESENT.

PLEASE READ ALL INSTRUCTIONS BEFORE PROCEEDING.

**IF IN ANY DOUBT WHEN FITTING OUR PRODUCTS, CONSULT ONE OF OUR DEALERS OR
HAVE FITTED BY A QUALIFIED TECHNICIAN.**

PLEASE NOTE THAT THE WAY THE KIT IS PACKED DOES NOT NECESSARILY REPRESENT THE WAY OF
MOUNTING TO THE BIKE.

IN THE EVENT OF RUBBER WASHERS BEING USED TO HOLD COMPONENTS ONTO BOLTS,
THESE RUBBER WASHERS CAN BE THROWN AWAY.

DIGITAL COPIES OF THESE INSTRUCTIONS ARE AVAILABLE FROM:

WWW.RG-RACING.COM

R&G, Unit 1, Shelley's Lane, East Worldham, Alton, Hampshire, GU34 3AQ
Tel: +44 (0)1420 89007 Fax: +44 (0)1420 87301 www.rg-racing.com Email: info@rg-racing.com



<u>TOOLS REQUIRED</u>	<u>GENERAL TORQUE SETTINGS</u>
<ul style="list-style-type: none"> • HEAT GUN OR LIGHTER • CABLE CUTTERS • ALLEN KEY SET TO INCLUDE 4, 5 & 6MM A/F SIZES. • SMALL FLAT HEAD SCREWDRIVER • SOCKET SET TO INCLUDE 6 & 8MM SOCKETS AND WRENCH. • PHILLIPS SCREWDRIVER. • SMALL AMOUNT OF SUPERGLUE. 	<p>M4 BOLT = 8Nm</p> <p>M5 BOLT = 12Nm</p> <p>M6 BOLT = 15Nm</p> <p>M8 BOLT = 20Nm</p> <p>M10 BOLT = 40Nm</p> <p>M12 BOLT = 40Nm</p>

LEGEND

ITEM NO.	DESCRIPTION	QTY
ITEM 1	TB0330 PART 1 - MAIN BRACKET	1
ITEM 2	TB0330 PART 2 - LICENCE PLATE BRACKET	1
ITEM 3	TB0330 PART 3 - COVER PLATE	1
ITEM 4	LA0002 NUMBER PLATE LIGHT (W/SHROUD)	1
ITEM 5	M6x1.00x16mm BUTTON HEAD BOLTS	4
ITEM 6	M6x1.00x6mm BUTTON HEAD BOLTS	3
ITEM 7	I0037 - OEM INDICATOR ADAPTORS	2
ITEM 8	I0016 - MINI INDICATOR ADAPTORS	4
ITEM 9	RB0002 RUBBER GROMMET	1
ITEM 10	CON0034 MINI INDICATOR CONNECTORS	2
ITEM 11	CON0077 LICENCE PLATE LIGHT CONNECTOR	1
ITEM 12	CT100 - CABLE TIES	3
ITEM 13	230MM LENGTH OF HEAT SHRINK	3
ITEM 14	SELF ADHESIVE CABLE CLIP	2
ITEM 15	IWC0002 INDICATOR WIRING COVERS	2
ITEM 16	REFLECTOR	1
ITEM 17	6.2MM DIAMETER FIR TREE CLIP	1
ITEM 18	7MM DIAMETER QUARTER TURN RIVET	2
ITEM 19	ITEM	



LP0330

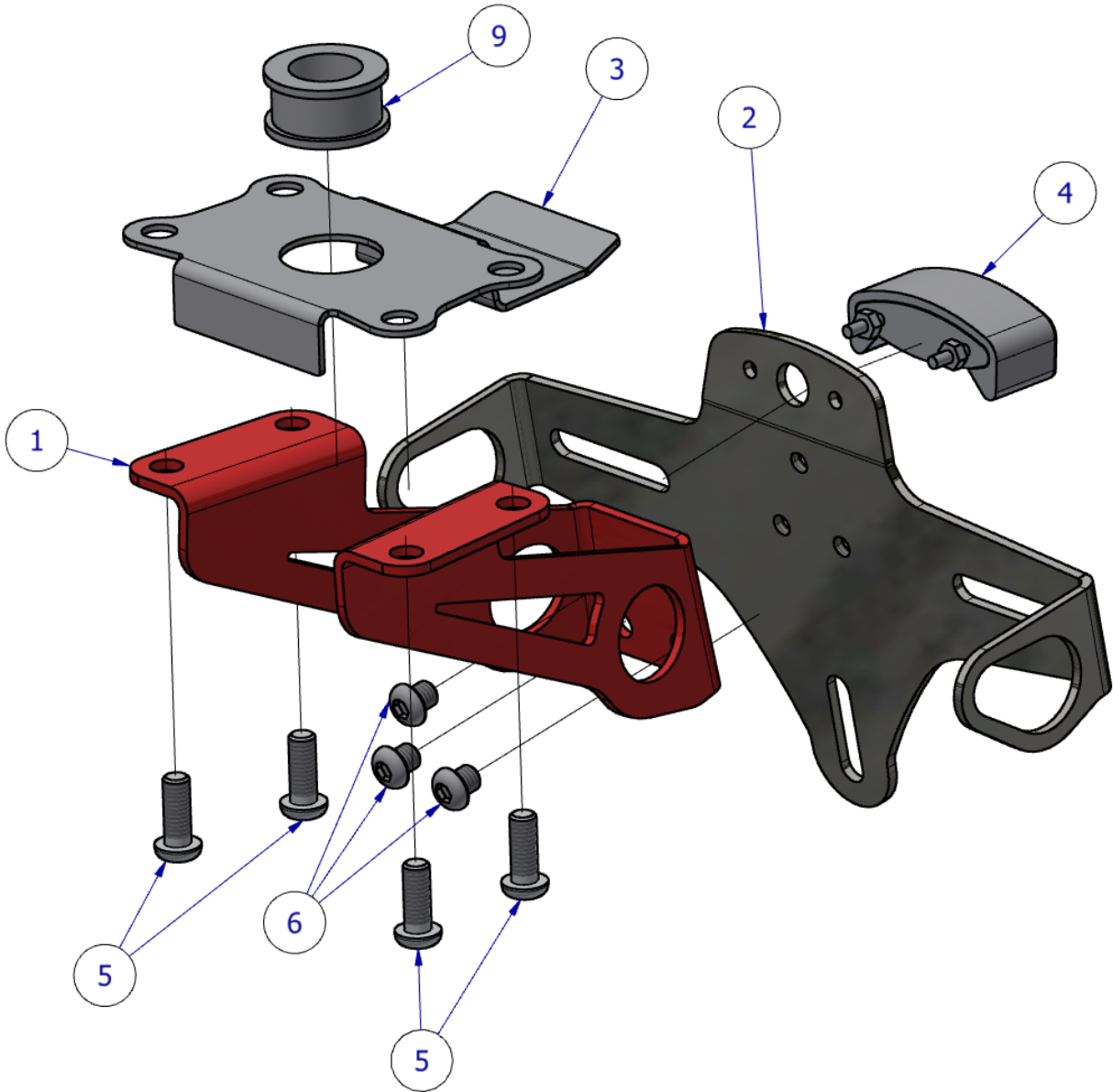

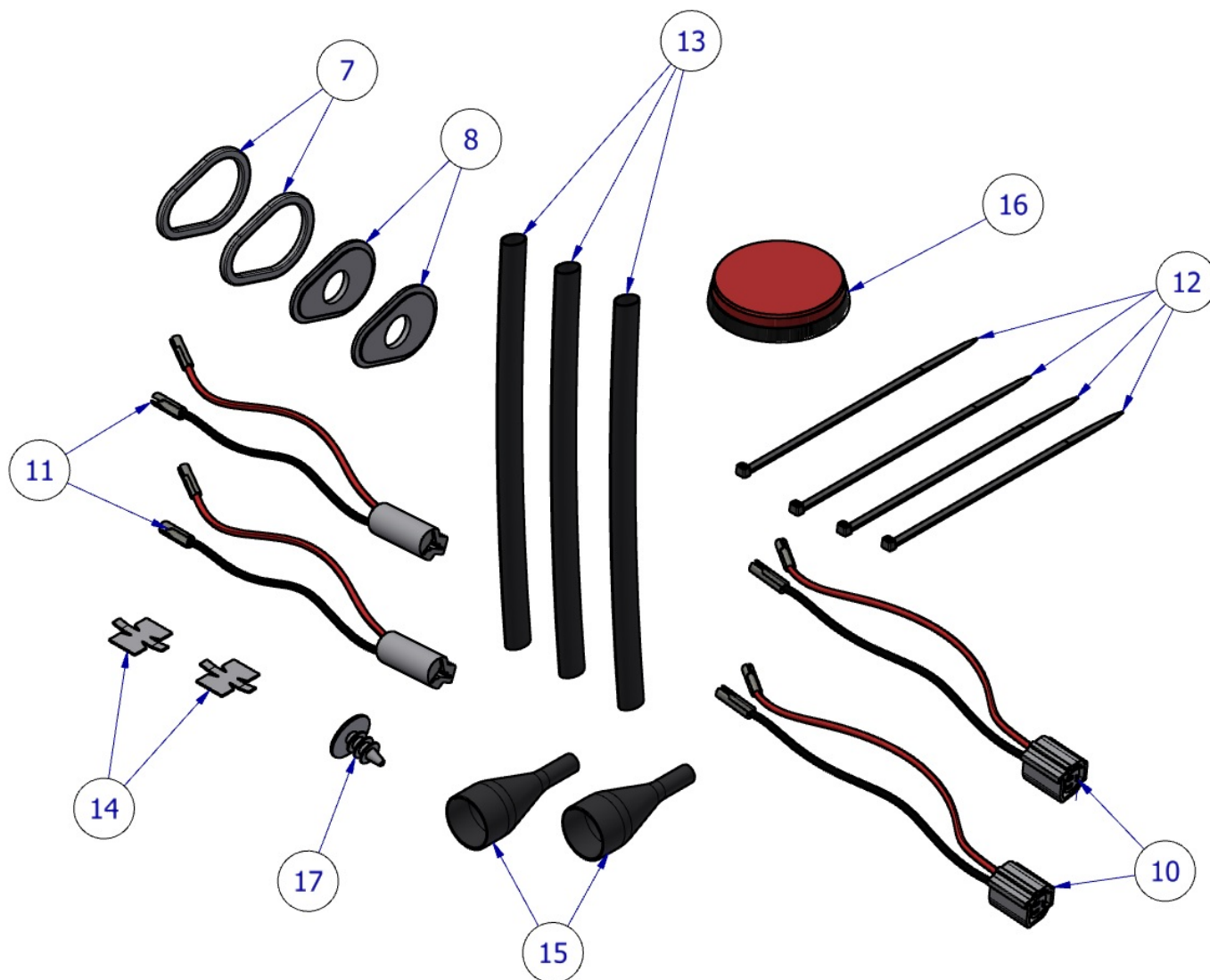

Picture 1

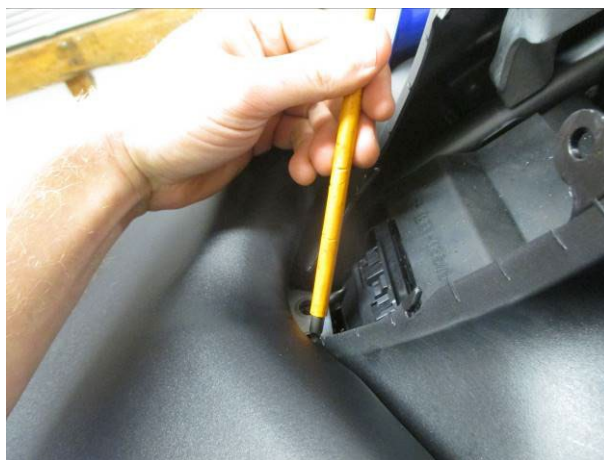

Picture 2



Picture 3



Picture 4



Picture 5



Picture 6



Picture 7



Picture 8



Picture 9

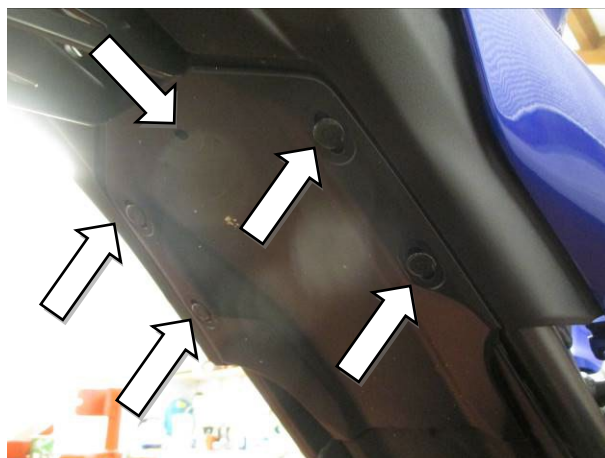

Picture 10



Picture 11



Picture 12

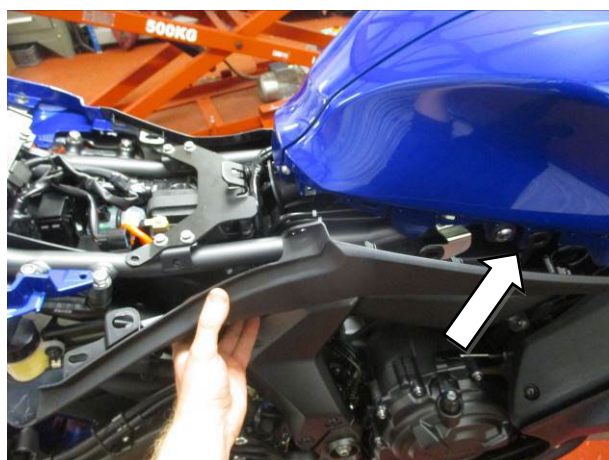

Picture 13



Picture 14



LP0330



Picture 15



Picture 16



Picture 17



Picture 18



Picture 19



Picture 20

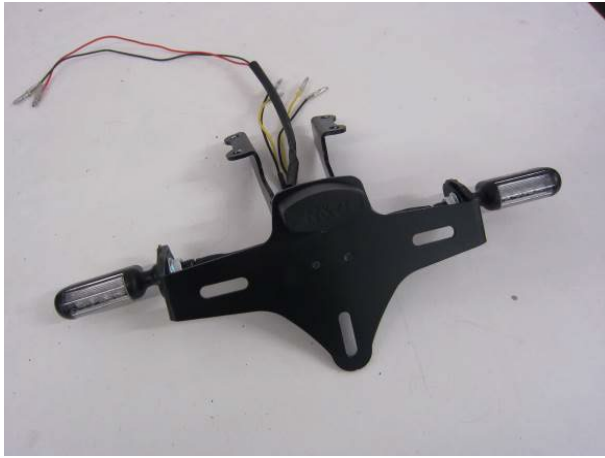

Picture 21

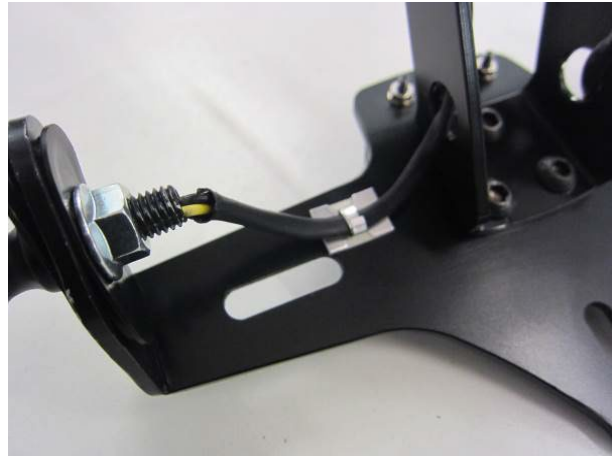

Picture 22



Picture 23



Picture 24

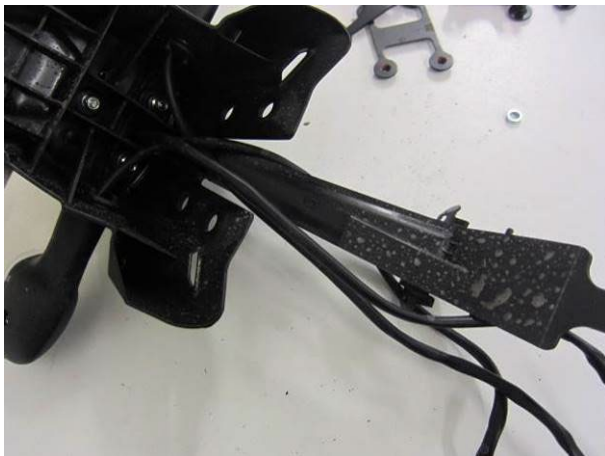

Picture 25



Picture 26



Picture 27



Picture 28



Picture 29



Picture 30



Picture 31



Picture 32

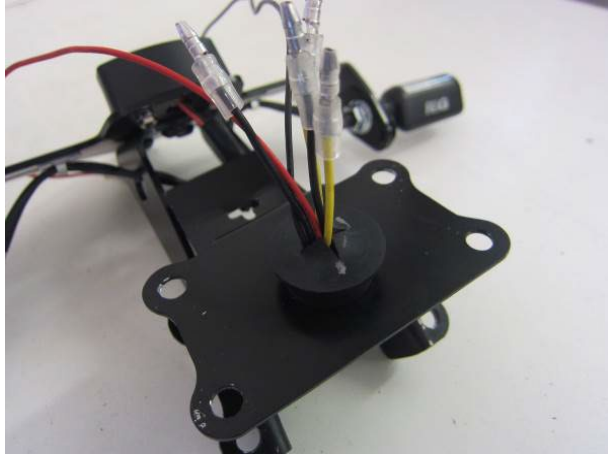

Picture 33

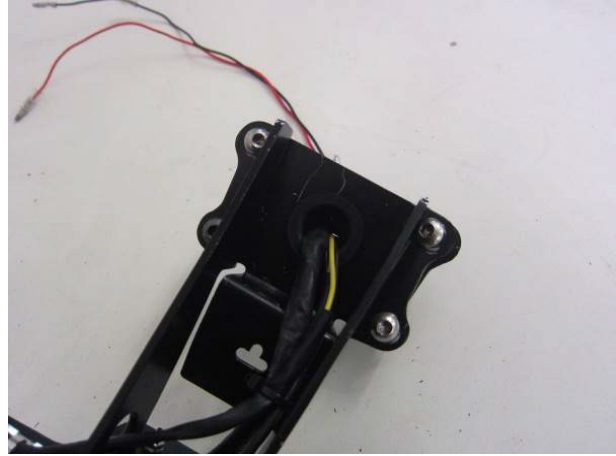

Picture 34



Picture 35



FITTING INSTRUCTIONS

- To fit the R&G tail tidy, remove the pillion seat using the key as shown in **picture 1**.
- Remove the rider's seat by removing the bolts securing the seat to the frame as shown in **picture 2**.
- Remove the central rubber piece connection the two tail fairings by removing the bolt shown in **picture 3**.

For each side

- Remove the 4 x Allen head bolts as shown in **pictures 4 & 5**.
- Remove the 2 x hex screw from the panels at the rear of the fuel tank as shown in **picture 6**.
- Remove the 2 x hex screws at the front of the black panels as shown in **picture 7**.
- Remove the hex 2 x bolts using a socket as shown in **picture 8**.
- Remove the fairing bolts from each side as shown in **picture 9**.
- Remove the 5 x push rivets shown in **picture 10**.
- Remove the lower mid panel from the underside of the tail piece as shown in **picture 11**.
- Remove the two pop rivets from the panels as shown in **picture 12**.
- Ensuring all bolts and rivets are removed, You can now remove the panel from the rubber mounted pins arrowed in **pictures 11 & 12**, starting at the front and pulling away from the bike gently until the pins release and you can remove the panel.

To assemble Tail tidy

- Take the R&G licence plate bracket (item 2 – TB0330 Part 2) and fit it to the main bracket (item 1 – TB0330 Part 1) using the three M6 x 6mm long button head bolts (item 6) and washers (item 17, as shown in **pictures 15 & 16**.
- Fit the R&G license plate illuminator (item 4) to the assembly, as shown in **picture 17**. Use a small amount of superglue to stick the light shroud in position. Fit one length of heatshrink to the wires and tighten the nuts on the rear, as shown in **picture 18**.
- If you intend to re-use the OEM indicators, skip the following stages.

To fit the R&G Mini Indicators

- Take one indicator, remove the nut and fit two of the Mini Indicator Adaptor plates (item 8 – I0016) (stepped faces facing each other) over the wires. (Please use the heat-shrink (item 13) to protect the indicator wires), as shown in picture 19.
- Locate these through either indicator mounting hole, as shown in picture 20.
- Fit the nut to the exposed thread and tighten in place, ensuring the stepped face on the adaptor plates locate correctly on either side of the metal bracket in the hole, as shown in picture 21.
- Place one IWC0002 (item 15) over the wires so that the large end covers the indicator nut.
- Repeat the above four steps for the remaining indicator.
- The wiring can now be fed through the two holes on either side of the main bracket and secured in place using cable ties and the self-adhesive clips, as shown in picture 22 & 31.
- Attach the two CON0034 (item 10) to the indicator wires using the bullet connectors ensuring **BLACK to BLACK** and **YELLOW to BLACK**.



To fit the OEM indicators

- The OEM indicators first need to be removed from the OEM licence plate hanger.
- Take the already removed license plate hanger and remove the four bolts, as shown in picture 23.
- With all four bolts removed, the assembly should separate as seen in picture 24.
- Untuck the wiring from the plastic wiring channel, as shown in picture 25.
- On the inside of the indicators, there is a small plastic plate which locates inside the rubber housing of the indicator mount. Remove this plate and gently pull the indicator out of the hole, as shown in pictures 26 & 27.
- Take the OEM Indicator Adaptor plates (item 7 – I0037) and fit one to each indicator rubber, as shown in pictures 28 & 29.
- Locate the indicators through the indicator mounting hole on the tail tidy assembly (placing the correct side indicator on the correct side of the tail tidy, as previously marked on the wiring) and re-fit the small plastic plate inside the rubber to securely mount the indicator, as shown in picture 30.
- For OEM indicators you may need to cut the rubber bung as shown in picture 31 to fit the connector through.

Tail Tidy Fitting

- With indicators now attached CON0077 (item 11) should be attached to the R&G number plate light wires, ensure to match *BLACK to BLACK* and *GREEN to RED*
- The wiring can now be fed through the two holes on either side of the main bracket and secured in place using cable ties and the self-adhesive clips (item 14), as shown in picture 22.
- Take the cover plate (item 3 – TB0159 Part 3) and fit the rubber grommet (item 9) through the central hole, as shown in picture 32.
- Offer up to the tail tidy assembly, ensuring it is orientated the correct way and feed the wiring through the rubber grommet
- Align the four holes and fit the four M6 x 16mm long button head bolts (item 5) through the main bracket and then the cover plate, as shown in picture 33.
- Offer the assembly up to the underside of the bike, feeding the wires through the large hole in the rear subframe, and loosely tighten the four M6 x 16mm long button head bolts (item 5) into the subframe mounts, as shown in pictures 34 & 35.
- Now carefully route the wires where they will not obstruct the seat mounting and simply reconnect the indicators and license plate light the correct connector on the main wiring harness, replace the cable clip removed previously as shown in picture 37.
- It is a good idea at this point to turn the ignition on and check for the correct operation of all lights.
- Cable tie the wiring neatly together and re-fit any clips previously removed using the cable ties provided (Item 12).
- Re-fit the plastic undertray, by locating the front tab into its housing, as shown in picture 38.
- Re-fit both side panels to the tail section, ensuring they slot over the undertray correctly.
- Re-fit the bolts and push rivets that secure the side panels in place.
- Re-fit the two OEM push rivets in the front two holes and the two push rivets supplied (item 18) in the rear two holes to secure the side panels to the undertray, as shown in picture 40. In the remaining central hole, fit the pine tree clip (item 17) supplied to blank this hole.
- Re-fit the remaining two bodywork joining panels and Philips screws.
- Ensure all bolts are tightened evenly.
- Re-fit the seat, securely mount the two bolts and re-fit the pillion seat.
- Re-fit the licence plate (it may require drilling).



- **IMPORTANT: IF FITTING A FULL-SIZE LICENCE PLATE AND PLACING IT FAR DOWN ON THE LICENCE PLATE HANGER, THERE IS A SMALL CHANCE OF THE LICENCE PLATE HITTING THE BACK WHEEL UNDER HEAVY LOAD AND OVER LARGE BUMPS IN THE ROAD. IT IS YOUR RESPONSIBILITY TO CHECK FOR THIS POSSIBILITY AND TAKE AVOIDING ACTION. FAILURE TO CHECK THIS COULD RESULT IN SERIOUS INJURY.**
- Depending on local laws, attach enclosed reflector (item 17) in an appropriate location.
- Test the license plate illuminator and all lights before riding.

ISSUE 1 20/01/21 (DM)

CONSUMER NOTICE

The catalogue description and any exhibition of samples are only broad indications of the Products and R&G may make design changes which do not diminish their performance or visual appeal and supplying them in such state shall conform to the order. The Buyer acknowledges no representation or warranty (other than as to title) has been given or will apply to the Products other than those in R&G's order or confirmation and the Buyer confirms it has chosen the Products as being of merchantable quality and suitable for its particular purposes. Where R&G fits the Products or undertakes other services it shall exercise reasonable skill and care and rectify any fault free of charge unless the workmanship has been disturbed. The Buyer is responsible for ensuring that the warranty on the motorcycle is not affected by the fitting of the Products. On return of any defective Products R&G shall at its option either supply a replacement or refund the purchase money but shall not be liable if the Products have been modified or used or maintained otherwise than in accordance with R&G's or manufacturer's instructions and good engineering practice or if the defect arises from accident or neglect. Other than identified above and subject to R&G not limiting its liability for causing death and personal injury, it shall not be liable for indirect or consequential loss and otherwise its liability shall be limited to the amounts paid by the Buyer for the Products or the fitting or service concerned. These terms do not affect the Buyer's statutory rights.

R&G RETURNS POLICY (NON-FAULTY GOODS)

Returns must be pre-authorized (if not pre-authorized the return will be rejected). Goods may only be returned direct to us if they were purchased direct from us (customer must prove if necessary). Otherwise to be returned to original vendor. Goods must be in re-sellable condition, in the opinion of R&G. All returns are subject to a 25% restocking and handling fee (25% of the gross value exc. P&P – at the prevailing price at time of purchase). The customer must pay any and all carriage charges. No returns of discontinued products, unless within 14 days of purchase. This policy does not affect your statutory rights and does not refer to faulty goods.