



FITTING INSTRUCTIONS FOR LP0346 LICENCE PLATE BRACKET



This kit contains the items pictured and labelled over page.

Some parts may be shown for clarity of instructions only.

Do not proceed until you are sure all parts are present.

Please read all instructions before proceeding.

**IF IN ANY DOUBT WHEN FITTING OUR PRODUCTS, CONSULT ONE OF OUR DEALERS
OR HAVE FITTED BY A QUALIFIED TECHNICIAN.**

Please note that the way the kit is packed does not necessarily represent the way of mounting to the bike.

In the event of rubber washers being used to hold components onto bolts, these rubber washers can be thrown away.

DIGITAL COPIES OF THESE INSTRUCTIONS ARE AVAILABLE FROM

WWW.RG-RACING.COM

R&G

Unit 1, Shelley's Lane, East Worldham, Alton, Hampshire, GU34 3AQ

Tel: +44 (0)1420 89007 Fax: +44 (0)1420 87301 www.rg-racing.com Email: info@rg-racing.com



<u>TOOLS REQUIRED</u>	<u>GENERAL TORQUE SETTINGS</u>
<ul style="list-style-type: none"> • Set of metric Hex keys to include 3mm, 4mm and 5mm. <ul style="list-style-type: none"> • T30 Torx head tool • Set of metric sockets and wrench. To include 6, 8 & 10mm. <ul style="list-style-type: none"> • 8mm & 10mm spanners. • Phillips screwdriver. 	M4 BOLT = 8Nm M5 BOLT = 12Nm M6 BOLT = 15Nm M8 BOLT = 20Nm M10 BOLT = 40Nm M12 BOLT = 40Nm

LEGEND

ITEM No.	DESCRIPTION	QTY
ITEM 1	TB0346 PART 1 LICENCE PLATE BRACKET	1
ITEM 2	TB0346 PART 2 LICENCE PLATE SUPPORT	1
ITEM 3	LA0011 SMALL SMOKED TAILLIGHT	1
ITEM 4	RB0013 G10-RSB320-40-00F RUBBER GROMMET	1
ITEM 5	M6x1.0x25mm BUTTON HEAD BOLT	10
ITEM 6	M6x12mm OD WASHER	20
ITEM 7	M6x1.0mm NYLOC NUTS	10
ITEM 8	666-896 150mm LENGTH OF HEAT-SHRINK	3
ITEM 9	CT100BK 2.5x100mm LONG CABLE TIES	3
ITEM 10	REFL 3 REFLECTOR	1
ITEM 11	RGS0002 SMALL STICKERS	2
ITEM 12	CON0040 TAILLIGHT ILLUMINATOR CONNECTOR	1
ITEM 13	M4x0.75x6mm BUTTON HEAD BOLT	

R&G

Unit 1, Shelley's Lane, East Worldham, Alton, Hampshire, GU34 3AQ

Tel: +44 (0)1420 89007 Fax: +44 (0)1420 87301 www.rg-racing.com Email: info@rg-racing.com



ASSEMBLY DIAGRAM 1

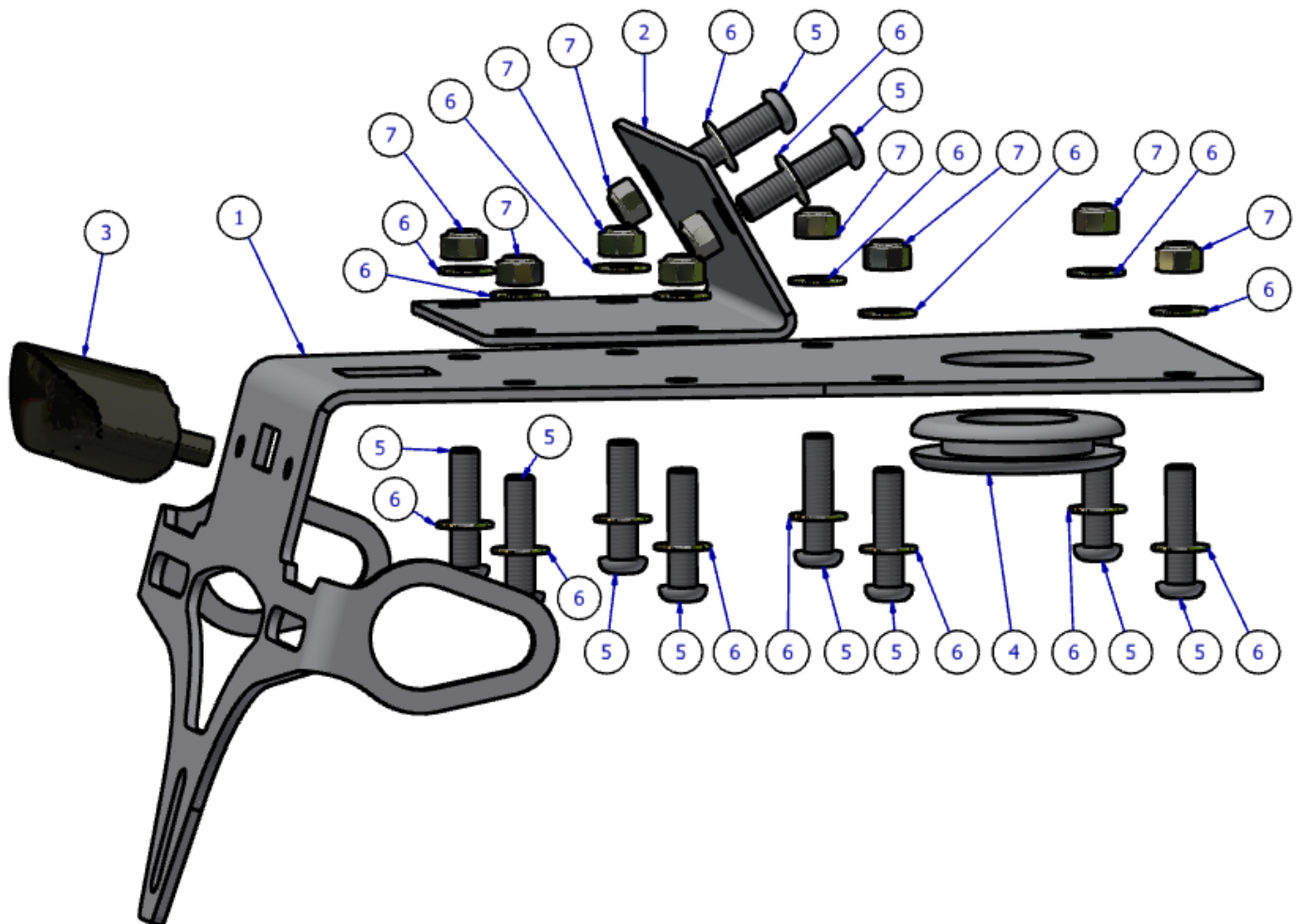

R&G

Unit 1, Shelley's Lane, East Worldham, Alton, Hampshire, GU34 3AQ

Tel: +44 (0)1420 89007 Fax: +44 (0)1420 87301 www.rg-racing.com Email: info@rg-racing.com



ASSEMBLY DIAGRAM 2

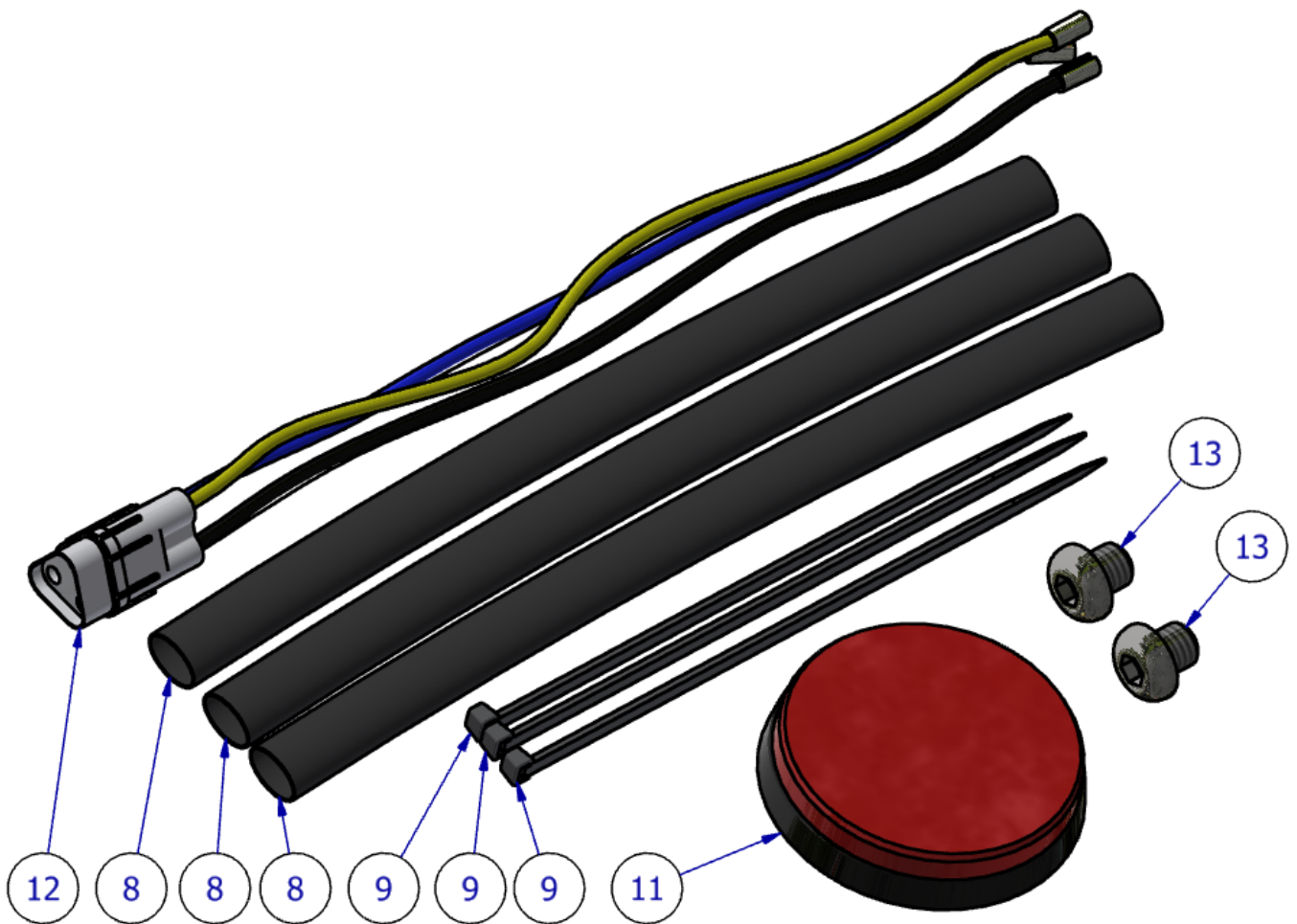



FITTING PICTURES



PICTURE 1



PICTURE 2

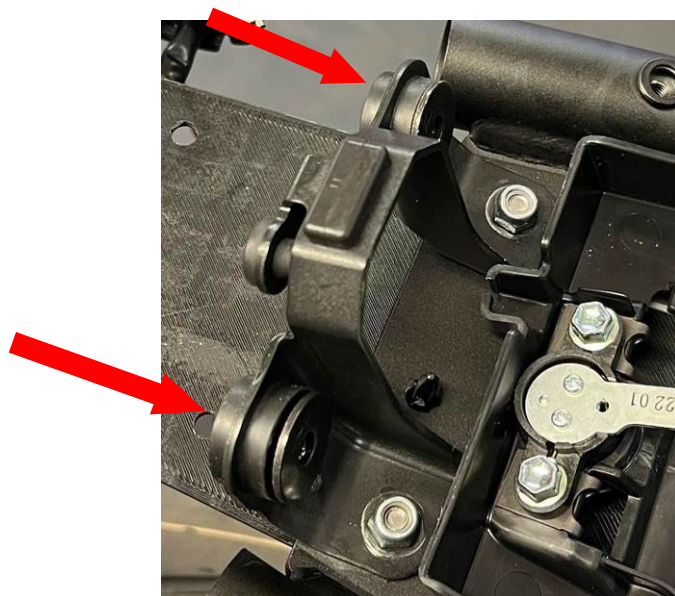

PICTURE 3



FITTING INSTRUCTIONS

Before fitting the R&G tail tidy you will need to remove some OEM parts. Below is a suggested list of parts to be removed.

- Seat
- Seat latch cover plate
- Unplug indicator's, number plate light and brake light wires
- OEM number plate bracket
- OEM indicators (re-use all components with Tail Tidy)
- Unplug indicator and number plate light wires
- OEM brake light (leave the rubber/ metal spacer in the mount)
- Brake light lower bump stop.

Tail Tidy Assembly

Before assembling this product, ensure all the components within the box are correct by comparing the **legend** and **diagrams**.

1. To start the assembly process, connect (**ITEM 1**) and (**ITEM 2**) together using x4 (**ITEM 5**) (**ITEM 7**) and x8 (**ITEM 6**). As shown in **DIAGRAM 1**.

DO NOT FULLY TIGHTEN AT THIS STAGE

2. Before the Rubber grommet (**ITEM 4**) can be mounted, you will need to cut a small cross into the centre of the flat face to make an access hole for the key to enter.
3. Now place the Rubber Grommet (**ITEM 4**) through the Licence plate bracket (**ITEM 1**) with the hole facing towards the top of the bike, as shown in **DIAGRAM 1**.
4. Apply the Heat shrink (**ITEM 8**) to the Small smoked taillight (**ITEM 3**) wires.
5. Next, mount the Small smoked taillight (**ITEM 3**) To the end of the licence plate bracket (**ITEM 1**). To do so use the M4x0.75x6mm Button head bolts (**ITEM 13**).

MAKE SURE (ITEM 3) WIRES ARE SLOTTED THROUGH THE TWO SQUARES SO THE WIRES ARE ON THE TOP SIDE OF THE TAIL TIDY AS SHOWN IN PICTURE 2

6. Now the assembly is ready to be mounted to the motorbike. To do so you will need x4 (**ITEM 5**) (**ITEM 7**) and x8 (**ITEM 6**). Use **DIAGRAM 1** to assist with where each ITEM goes.

MAKE SURE TO SLOT x1 WASHER (ITEM 6) ONTO ALL BOLTS (ITEM 5) BEFORE MOUNTING.

R&G

Unit 1, Shelley's Lane, East Worldham, Alton, Hampshire, GU34 3AQ

Tel: +44 (0)1420 89007 Fax: +44 (0)1420 87301 www.rg-racing.com Email: info@rg-racing.com



Now place the Tail tidy into the same mounting holes as the OEM number plate bracket and tighten the nuts and bolts to the correct torques settings using the **GENERAL TORQUE SETTINGS** on **page 2.**

7. The next step is to connect the Licence plate support (**ITEM 2**) to the OEM brake light mount. You will need x2 (**ITEM 5**) (**ITEM 6**) and (**ITEM 7**). Place the bolts (**ITEM 5**) with the washer (**ITEM 6**) placed over, through the OEM washer that is still connected to the motorbike and then through the Licence plate support (**ITEM 2**) and tighten it down with a nut (**ITEM 7**). Use **PICTURE 3** for an example of where the OEM brake light mount is located.

Tighten the nuts and bolts to the correct torques settings using the **GENERAL TORQUE SETTINGS** on **page 2.**

8. Connect Taillight illuminator connector (**ITEM 12**) to the Small smoked taillight (**ITEM 3**) wires as shown in **PICTURE 1.**

9. Now tighten the Licence plate bracket (**ITEM 1**) and Licence plate support (**ITEM 2**) together as step (**1.**) originally stated not to tighten.

10. Fit the OEM indicators into the new Tail tidy assembly and place the wires through the square hole as shown in **PICTURE 2.** Then plug them back into the OEM connectors. (Cable ties (**ITEM 9**) can be used to tidy the cables underneath the seat).

ENSURE INDICATORS ARE CORRECT WAY AROUND.

11. Final step, re-install all OEM parts except from the OEM Number Plate Bracket and OEM Brake Light. (The reflector (**ITEM 11**) is within the kit in case a new number plate is required).

IMPORTANT: IF FITTING A FULL-SIZE LICENCE PLATE AND PLACING IT LOW DOWN ON THE LICENCE PLATE MOUNT, THERE IS A POTENTIAL CHANCE THE LICENCE PLATE COULD HIT THE BACK WHEEL UNDER HEAVY LOAD AND OVER LARGE BUMPS IN THE ROAD. IT IS YOUR RESPONSIBILITY TO CHECK FOR THIS POSSIBILITY AND TAKE AVOIDING ACTION. FAILURE TO CHECK THIS COULD RESULT IN SERIOUS INJURY.

ISSUE 1 10/10/2022 (JH)

CONSUMER NOTICE

The catalogue description and any exhibition of samples are only broad indications of the Products and R&G may make design changes which do not diminish their performance or visual appeal and supplying them in such state shall conform to the order. The Buyer acknowledges no representation or warranty (other than as to title) has been given or will apply to the Products other than those in R&G's order or confirmation and the Buyer confirms it has chosen the Products as being of merchantable quality and suitable for its particular purposes. Where R&G fits the Products or undertakes other services it shall exercise reasonable skill and care and rectify any fault free of charge unless the workmanship has been disturbed. The Buyer is responsible for ensuring that the warranty on the motorcycle is not affected by the fitting of the Products. On return of any defective Products R&G shall at its option either supply a replacement or refund the purchase money but shall not be liable if the Products have been modified or used or maintained otherwise than in accordance with R&G's or manufacturer's instructions and good engineering practice or if the defect arises from accident or neglect. Other than identified above and subject to R&G not limiting its liability for causing death and personal injury, it shall not be liable for indirect or consequential loss and otherwise its liability

R&G

Unit 1, Shelley's Lane, East Worldham, Alton, Hampshire, GU34 3AQ

Tel: +44 (0)1420 89007 Fax: +44 (0)1420 87301 www.rg-racing.com Email: info@rg-racing.com



shall be limited to the amounts paid by the Buyer for the Products or the fitting or service concerned. These terms do not affect the Buyer's statutory rights.

R&G RACING RETURNS POLICY (NON-FAULTY GOODS)

Returns must be pre-authorized (if not pre-authorized the return will be rejected). Goods may only be returned direct to us if they were purchased direct from us (customer must prove if necessary). Otherwise to be returned to original vendor. Goods must be in re-sellable condition, in the opinion of R&G Racing. All returns are subject to a 25% restocking and handling fee (25% of the gross value exc. P&P - at the prevailing price at time of purchase). The customer must pay any and all carriage charges. No returns of discontinued products, unless within 14 days of purchase. This policy does not affect your statutory rights and does not refer to faulty goods.

R&G

Unit 1, Shelley's Lane, East Worldham, Alton, Hampshire, GU34 3AQ

Tel: +44 (0)1420 89007 Fax: +44 (0)1420 87301 www.rg-racing.com Email: info@rg-racing.com



NOTICE DE MONTAGE POUR LP0346 SUPPORT DE PLAQUE



CE KIT CONTIENT LES ARTICLES ILLUSTRÉS ET ÉTIQUETES SUR LA PAGE.

CERTAINES PARTIES PEUVENT ÊTRE PRÉSENTES UNIQUEMENT POUR LA CLARTÉ DES INSTRUCTIONS.

NE PAS PROCÉDER AU MONTAGE TANT QUE VOUS N'ÊTES PAS SÛR QUE TOUTES LES PIÈCES SOIENT PRÉSENTES.

VEUILLEZ LIRE TOUTES LES INSTRUCTIONS AVANT DE CONTINUER.

EN CAS DE DOUTE LORS DU MONTAGE DE NOS PRODUITS, CONSULTEZ UN DE NOS REVENDEURS OU FAITES APPEL À UN TECHNICIEN QUALIFIÉ.

VEUILLEZ NOTER QUE LA FAÇON DONT LE KIT EST EMBALLÉ NE REPRÉSENTE PAS NECESSAIREMENT LA MANIÈRE DE LE MONTER SUR LA MOTO.

SI DES RONDELLES EN CAOUTCHOUC SONT UTILISÉES POUR MAINTENIR LES COMPOSANTS SUR LES BOULONS, ELLES PEUVENT ÊTRE JETÉES.

NOTICE DISPONIBLE AU TÉLÉCHARGEMENT SUR : WWW.RG-RACING.COM

R&G

Unit 1, Shelley's Lane, East Worldham, Alton, Hampshire, GU34 3AQ

Tel: +44 (0)1420 89007 Fax: +44 (0)1420 87301 www.rg-racing.com Email: info@rg-racing.com



<u>OUTILS REQUIS</u>	<u>VALEURS DE SERRAGE</u>
<ul style="list-style-type: none"> • Clés hexagonales 3mm, 4mm et 5mm. <ul style="list-style-type: none"> • Clé Torx T30 • Clé à cliquet + douilles 6, 8 & 10mm. • Clé.à molette 8mm & 10mm. <ul style="list-style-type: none"> • Tournevis cruciform. 	M4 BOULON = 8Nm M5 BOULON = 12Nm M6 BOULON = 15Nm M8 BOULON = 20Nm M10 BOULON = 40Nm M12 BOULON = 40Nm

LÉGENDE

ARTICLE No.	DESCRIPTION	QTÉ
ARTICLE 1	TB0346 PART 1 SUPPORT DE PLAQUE	1
ARTICLE 2	TB0346 PART 2 SUPPORT DE PLAQUE	1
ARTICLE 3	LA0011 PETIT FEU ARRIÈRE FUMÉ	1
ARTICLE 4	RB0013 G10-RSB320-40-00F CÉILLET EN CAOUTCHOUC	1
ARTICLE 5	M6x1.0x25mm BOULON	10
ARTICLE 6	M6x12mm RONDELLE	20
ARTICLE 7	M6x1.0mm ÉCROUS	10
ARTICLE 8	666-896 150mm MANCHON THERMO RÉTRACTABLE	3
ARTICLE 9	CT100BK 2.5x100mm COLLIERS DE SERRAGE	3
ARTICLE 10	REFL 3 RÉFLECTEUR	1
ARTICLE 11	RG50002 PETITS STICKERS	2
ARTICLE 12	CON0040 CONNECTEUR DE FEU DE PLAQUE	1
ARTICLE 13	M4x0.75x6mm BOULON	

R&G

Unit 1, Shelley's Lane, East Worldham, Alton, Hampshire, GU34 3AQ

Tel: +44 (0)1420 89007 Fax: +44 (0)1420 87301 www.rg-racing.com Email: info@rg-racing.com



SCHÉMA D'ASSEMBLAGE 1

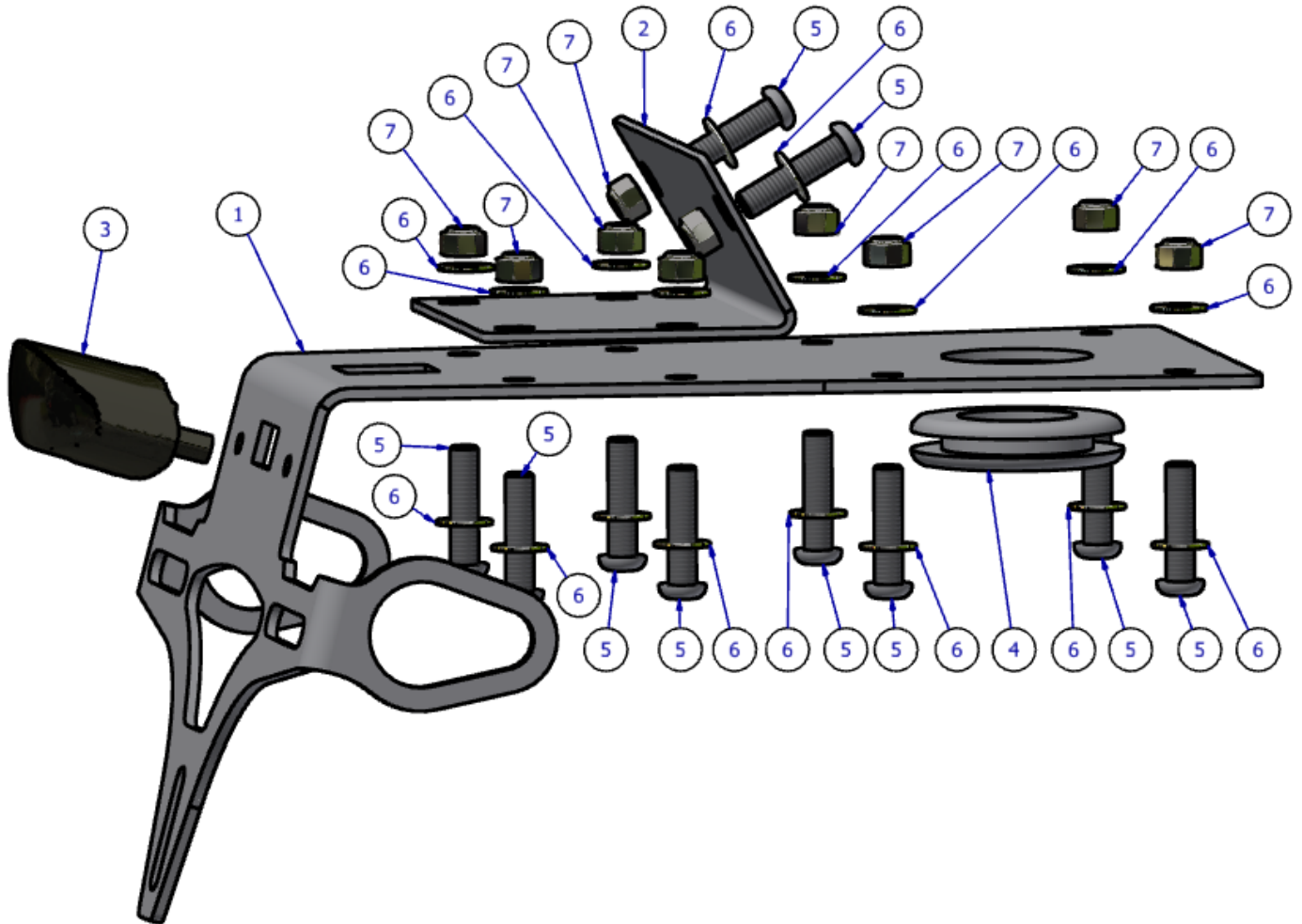

R&G

Unit 1, Shelley's Lane, East Worldham, Alton, Hampshire, GU34 3AQ

Tel: +44 (0)1420 89007 Fax: +44 (0)1420 87301 www.rg-racing.com Email: info@rg-racing.com



SCHÉMA D'ASSEMBLAGE 2

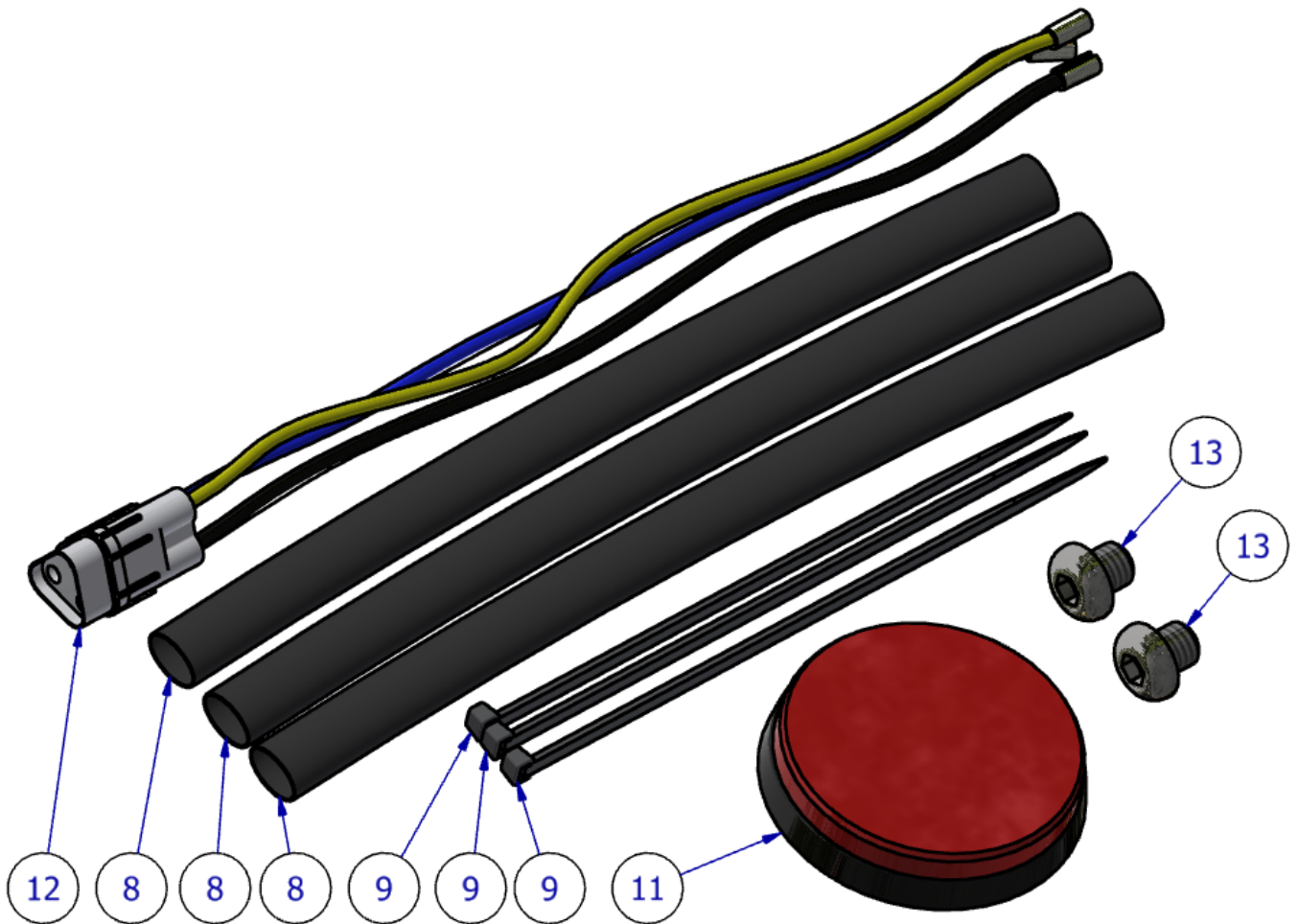

R&G

Unit 1, Shelley's Lane, East Worldham, Alton, Hampshire, GU34 3AQ

Tel: +44 (0)1420 89007 Fax: +44 (0)1420 87301 www.rg-racing.com Email: info@rg-racing.com



PHOTOS DE MONTAGE



PHOTO 1



PHOTO 2

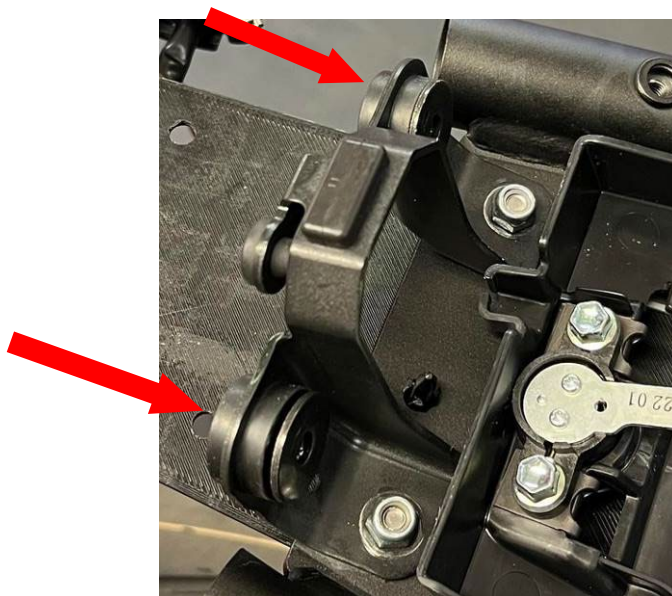

PHOTO 3



NOTICE DE MONTAGE

Avant de monter le support arrière R&G, vous devrez retirer certaines pièces d'origine. Vous trouverez ci-dessous une liste suggérée de pièces à retirer.

- Siège
- Plaque de recouvrement du loquet de siège
- Débranchez les fils des clignotants, des feux de plaque d'immatriculation et des feux de freinage
- Support de plaque d'origine
- Clignotants d'origine (Réutiliser tous les composants avec support)
- Débranchez les fils des clignotants et des feux de plaque d'immatriculation
- Feu stop d'origine (laissez l'entretoise en caoutchouc/métal dans le support)
- Butée inférieure de feu stop.

Assemblage de support de plaque

Avant d'assembler ce produit, assurez-vous que tous les composants de la boîte soient corrects en comparant la légende et les schémas.

12. Pour démarrer le processus d'assemblage, connectez (ARTICLE 1) et (ARTICLE 2) ensemble en utilisant x4 (ARTICLE 5) (ARTICLE 7) et x8 (ARTICLE 6). Comme indiqué sur le SCHÉMA 1.

NE PAS SERRER COMPLÈTEMENT POUR LE MOMENT

13. Avant que l'œillet en caoutchouc (ARTICLE 4) puisse être monté, vous devrez couper une petite croix au centre de la face plate pour faire un trou d'accès pour que la clé puisse entrer.

14. Placez maintenant l'œillet en caoutchouc (ARTICLE 4) à travers le support de plaque d'immatriculation (ARTICLE 1) avec le trou orienté vers le haut de la moto, voir le SCHÉMA 1.

15. Appliquez la thermo rétractable (ARTICLE 8) sur les fils du petit feu arrière fumé (ARTICLE 3).

16. Ensuite, montez le petit feu arrière fumé (ARTICLE 3) à l'extrémité du support de plaque (ARTICLE 1). Pour ce faire, utilisez les boulons à tête ronde M4x0,75x6mm (ARTICLE 13).

ASSUREZ-VOUS (ARTICLE 3) QUE LES FILS SOIENT FENDUS À TRAVERS LES DEUX CARRÉS DE SORTE QUE LES FILS SOIENT SUR LE CÔTÉ SUPÉRIEUR DU SUPPORT, COMME INDIQUÉ SUR LA PHOTO 2.

17. L'ensemble est maintenant prêt à être monté sur la moto. Pour ce faire, vous aurez besoin de x4 (ARTICLE 5) (ARTICLE 7) et x8 (ARTICLE 6). Utilisez le SCHÉMA 1 pour vous aider à savoir où va chaque ARTICLE.

ASSUREZ-VOUS D'INSTALLER x1 RONDELLE (ARTICLE 6) SUR TOUS LES BOULONS (ARTICLE 5) AVANT LE MONTAGE.

R&G

Unit 1, Shelley's Lane, East Worldham, Alton, Hampshire, GU34 3AQ

Tel: +44 (0)1420 89007 Fax: +44 (0)1420 87301 www.rg-racing.com Email: info@rg-racing.com



Placez maintenant le support arrière dans les mêmes trous de montage que le support de plaque d'immatriculation d'origine et serrez les écrous et les boulons aux réglages de couple corrects en utilisant les RÉGLAGES GÉNÉRAUX DE COUPLE à la page 2.

18. L'étape suivante consiste à connecter le support de plaque d'immatriculation (ARTICLE 2) au support de feu stop d'origine. Vous aurez besoin de x2 (ARTICLE 5) (ARTICLE 6) et (ARTICLE 7). Placez les boulons (ARTICLE 5) avec la rondelle (ARTICLE 6) placée au-dessus, à travers la rondelle d'origine qui est toujours connectée à la moto, puis à travers le support de plaque d'immatriculation (ARTICLE 2) et serrez-le avec un écrou (ARTICLE 7) . Utilisez la PHOTO 3 pour observer l'emplacement du support de feu stop d'origine.

Serrez les écrous et les boulons aux couples corrects en utilisant les RÉGLAGES GÉNÉRAUX DE COUPLE à la page 2.

19. Connectez le connecteur de feu arrière (ARTICLE 12) aux fils du petit feu arrière fumé (ARTICLE 3) comme indiqué sur la PHOTO 1.

20. Serrez maintenant le support de plaque d'immatriculation (ARTICLE 1) et le support de plaque d'immatriculation (ARTICLE 2) ensemble comme l'étape (1.) a initialement indiqué de ne pas serrer.

21. Installez les clignotants d'origine dans le nouvel ensemble de support arrière et placez les fils à travers le trou carré comme indiqué sur la PHOTO 2. Ensuite, rebranchez-les dans les connecteurs d'origine. (Des attaches de câble (ARTICLE 9) peuvent être utilisées pour ranger les câbles sous le siège).

ASSUREZ-VOUS QUE LES CLIGNOTANTS SOIENT CORRECTS.

22. Dernière étape, réinstallez toutes les pièces d'origine à l'exception du support de plaque d'immatriculation d'origine et du feu stop d'origine. (Le réflecteur (ARTICLE 11) se trouve dans le kit au cas où une nouvelle plaque d'immatriculation serait nécessaire).

IMPORTANT : SI VOUS MONTEZ UNE PLAQUE D'IMMATRICULATION DE GRANDE TAILLE ET LA PLACEZ BIEN EN BAS SUR LE SUPPORT DE PLAQUE D'IMMATRICULATION, IL Y A UN RISQUE QUE LA PLAQUE D'IMMATRICULATION FRAPPE LA ROUE ARRIÈRE SOUS UNE CHARGE LOURDE ET SUR DE GROSSES BOSSES SUR LA ROUTE. IL EST DE VOTRE RESPONSABILITÉ DE VÉRIFIER CETTE POSSIBILITÉ ET DE PRENDRE DES MESURES POUR ÉVITER. NE PAS VÉRIFIER CELA POURRAIT ENTRAÎNER DES BLESSURES GRAVES.

ISSUE 1 10/10/2022 (JH)

CONSUMER NOTICE

The catalogue description and any exhibition of samples are only broad indications of the Products and R&G may make design changes which do not diminish their performance or visual appeal and supplying them in such state shall conform to the order. The Buyer acknowledges no representation or warranty (other than as to title) has been given or will apply to the Products other than those in R&G's order or confirmation and the Buyer confirms it has chosen the Products as being of merchantable quality and suitable for its particular purposes. Where R&G fits the Products or undertakes other services it shall exercise reasonable skill and care and rectify any fault free of charge unless the workmanship has been disturbed. The Buyer is responsible for

R&G

Unit 1, Shelley's Lane, East Worldham, Alton, Hampshire, GU34 3AQ

Tel: +44 (0)1420 89007 Fax: +44 (0)1420 87301 www.rg-racing.com Email: info@rg-racing.com



ensuring that the warranty on the motorcycle is not affected by the fitting of the Products. On return of any defective Products R&G shall at its option either supply a replacement or refund the purchase money but shall not be liable if the Products have been modified or used or maintained otherwise than in accordance with R&G's or manufacturer's instructions and good engineering practice or if the defect arises from accident or neglect. Other than identified above and subject to R&G not limiting its liability for causing death and personal injury, it shall not be liable for indirect or consequential loss and otherwise its liability shall be limited to the amounts paid by the Buyer for the Products or the fitting or service concerned. These terms do not affect the Buyer's statutory rights.

R&G RACING RETURNS POLICY (NON-FAULTY GOODS)

Returns must be pre-authorized (if not pre-authorized the return will be rejected). Goods may only be returned direct to us if they were purchased direct from us (customer must prove if necessary). Otherwise to be returned to original vendor. Goods must be in re-sellable condition, in the opinion of R&G Racing. All returns are subject to a 25% restocking and handling fee (25% of the gross value exc. P&P - at the prevailing price at time of purchase). The customer must pay any and all carriage charges. No returns of discontinued products, unless within 14 days of purchase. This policy does not affect your statutory rights and does not refer to faulty goods.

R&G

Unit 1, Shelley's Lane, East Worldham, Alton, Hampshire, GU34 3AQ

Tel: +44 (0)1420 89007 Fax: +44 (0)1420 87301 www.rg-racing.com Email: info@rg-racing.com