

BIKE	HONDA CBR 600 RR	PART NO.	HA-102
YEAR	2007-12	FIT KITS	OVAL Z039.11235
NOTES	Use standard fittings where not supplied Remove standard gasket if fitted.	FEATURES	SCEXDBK08 - (Type H)

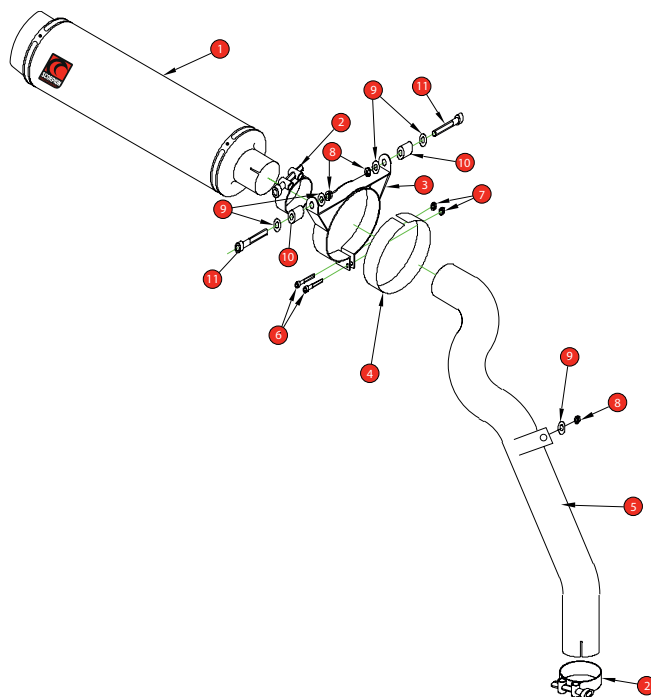

1 350mm Underseat Silencer ESC 106	8 3 x M6 Nyloc Nuts (Z017.10033)
2 2 x 51-55mm Band Clamp (Z016.10002)	9 5 x M6 Washers (Z017.12722)
3 Oval Composite silencer strap (Z028.10185)	10 2 x 15mm Aluminium Spacers (Z026.10005)
4 Protective Rubber Strip (Z029.10022)	11 2 x M6 x 45mm Cap Head Bolts (Z017.12740)
5 Connecting Pipe CP 424	12 Heatshield Cut Out Template + A4 Heatshield Material
6 2 x M5 x 15mm Cap Head Bolts (Z017.12710)	
7 2 x M5 Nyloc Nuts (Z017.12716)	

E-MARK ROUND	N/A
E-MARK OVAL	SC-106 e4 2293 9
ISSUE NO.	03
DATE	15/10/2018
AUTHORISED	J.Harkin
CHECKED	

NOTE: ENSURE SCORPION SYSTEM IS CLEAR OF MOVING PARTS AND ALL ORIGINAL FUNCTIONS WORK CORRECTLY.



Fitting instructions follow on next page.

Box: PLOCK 2

BIKE	HONDA CBR 600 RR	PART NO.	HA - 102
YEAR	2007 - 2009	FIT KITS	OVAL Z039.11235
NOTES	Use original Bolts & Spacers when not supplied	FEATURES	

CONTINUED FROM OVERLEAF:



A, B) Remove Both Seats

C) Remove 4 Seat Cowling Bolts & Gently Remove seat Cowl

D) Disconnect the Tail & Indicator Lights

E) Remove 4 Bolts Holding Number Plate Lights

F) Remove Plastic Side Panel (1 Bolt)

G) Remove Rear Footrest

H) Remove 2 Bolts In Footrest

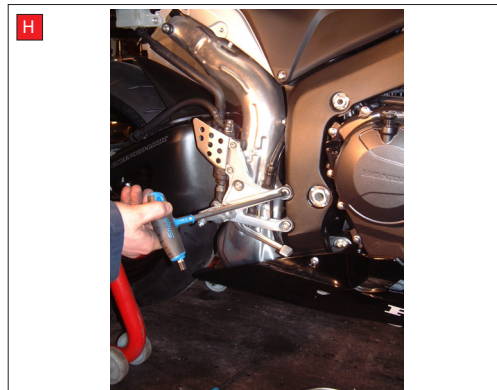
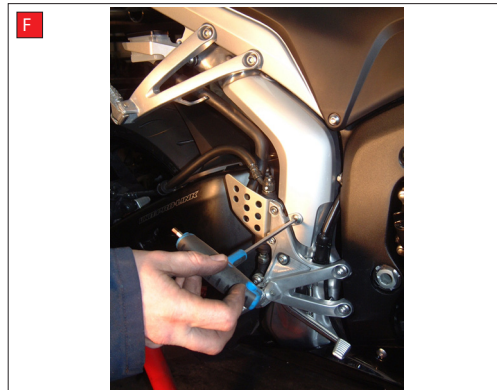

Box: PLOCK 2

BIKE	HONDA CBR 600 RR	PART NO.	HA - 102
YEAR	2007 - 2009	FIT KITS	OVAL Z039.11235
NOTES	Use original Bolts & Spacers when not supplied	FEATURES	

CONTINUED FROM OVERLEAF:

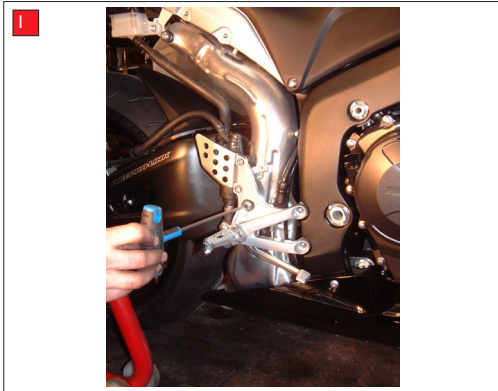

I) Remove 2 Bolts Holding Heatshield & Gently Remove

J) Loosen O.E Silencer Clamp

K) Remove All Bolts Holding O.E Silencer & Remove the Silencer

L) Remove Silencer Heatshield

M) Cut Out Replacement Heat shielding & Apply as per Picture

N) Bolt in Silencer Mounting Bracket Using Supplied Bolts & Spacers

O) Fit Scorpion Link Pipe & Silencer & Bolt Link Pipe, Tighten Silencer With Clamp

P) Then Tighten Silencer Band With Supplied Bolts

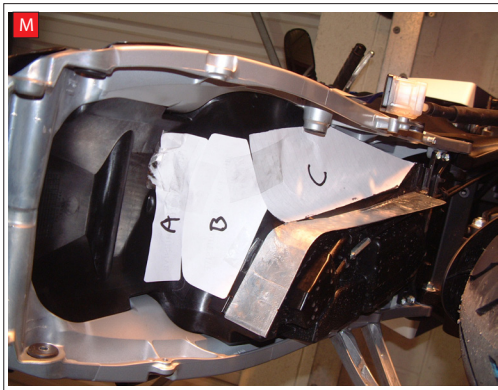

Re-Fit all components (Footrest, Connector Pipe Heatshield, Pillion Footrest, Number Plate & Lights Mounting Brackets, Seat Cowl, Plastic Side Panel and Both Seats) Ensure there is adequate clearance around silencer and link pipe and Scorpion supplied Heatshield is fitted correctly Ensure all original fittings are replaced and all original functions work correctly prior to use.