



FITTING INSTRUCTIONS FOR AB0032BK ADVENTURE BARS
KTM DUKE 125 + 390 2017



THIS KIT CONTAINS THE ITEMS PICTURED AND LABELLED BELOW.
DO NOT PROCEED UNTIL YOU ARE SURE ALL PARTS ARE PRESENT.

Please note that the way the kit is packed does not necessarily represent the way of mounting to the bike
Please note that in cases where kits are packed with rubber washers holding the components onto the bolt – *the rubber washers should be thrown away!*

THE PARTS SHOWN MAY BE REPRESENTATIVE ONLY (FOR CLARITY OF INSTRUCTIONS ONLY)

Digital copies of these instructions are available to download from www.rg-racing.com

R&G
Unit 1, Shelley's Lane, East Worldham, Alton, Hampshire, GU34 3AQ
Tel: +44 (0)1420 89007 Fax: +44 (0)1420 87301 www.rg-racing.com Email: info@rg-racing.com



GENERAL TORQUE SETTINGS

- M4 BOLT = 8Nm
- M5 BOLT = 12Nm
- M6 BOLT = 15Nm
- M8 BOLT = 20Nm
- M10 BOLT = 40Nm

TOOLS REQUIRED

- Socket set and wrench.
- Torque wrench (up to 40Nm).
 - Soft faced mallet.

THIS KIT INCLUDES:

1. 1 x CB066 CRASH BAR RIGHT BLACK
2. 1 x CB065 CRASH BAR LEFT BLACK
3. 2 x S1089 10mm SPACERS BLACK
4. 2 x S1088 12mm SPACERS BLACK
5. 1 x S1090 22mm SPACER BLACK
6. 2 x M8 x 1.25 x 40mm LONG CAP HEAD BOLTS STAINLESS
7. 2 x M8 x 1.25 x 45mm LONG CAP HEAD BOLTS STAINLESS
8. 1 x M10 x 1.5 x 160mm LONG HEX HEAD BOLTS
9. 4 x M8 WASHERS
10. 1 x M10 WASHERS
11. 4 x M8 CAP HEAD BOLT BLANKING CAP
12. 1 x M10 HEX HEAD COVER CAP

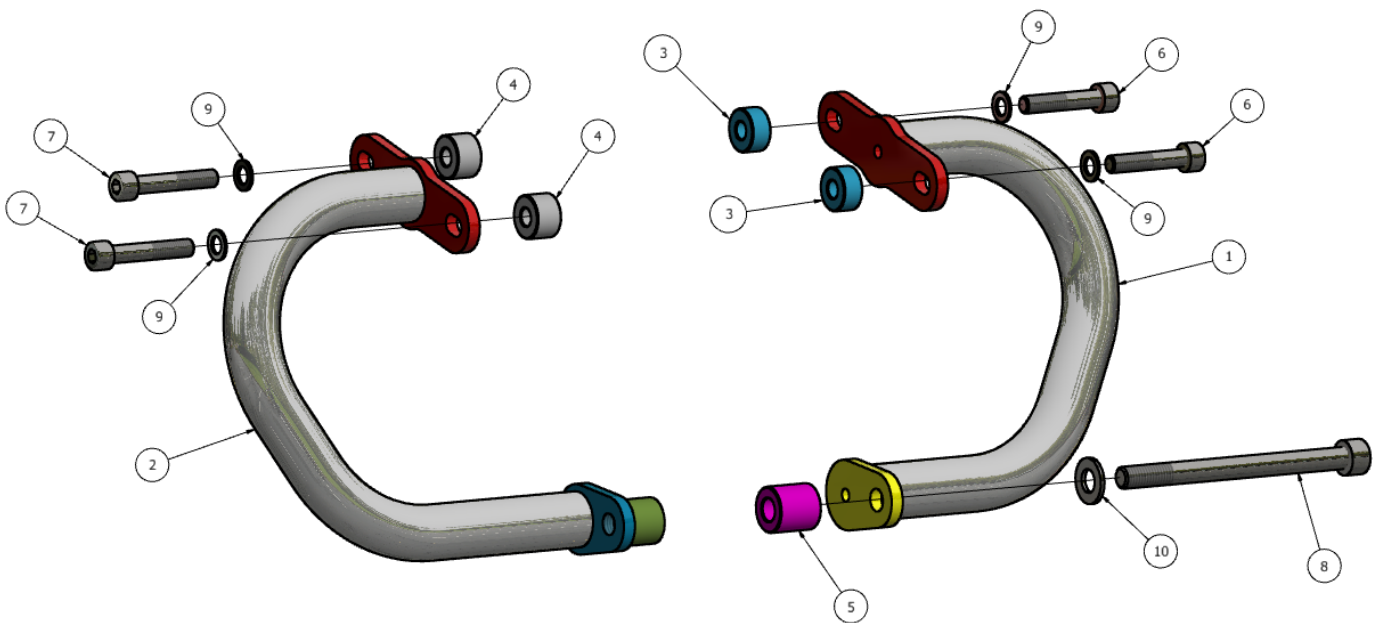

R&G

Unit 1, Shelley's Lane, East Worldham, Alton, Hampshire, GU34 3AQ

Tel: +44 (0)1420 89007 Fax: +44 (0)1420 87301 www.rg-racing.com Email: info@rg-racing.com

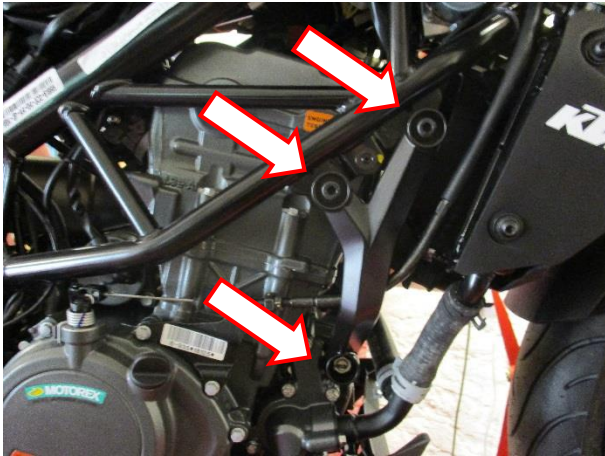

PICTURE 1



PICTURE 2

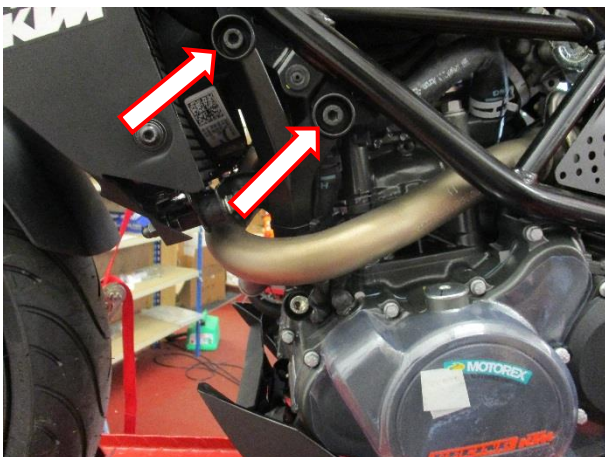

PICTURE 3



PICTURE 4

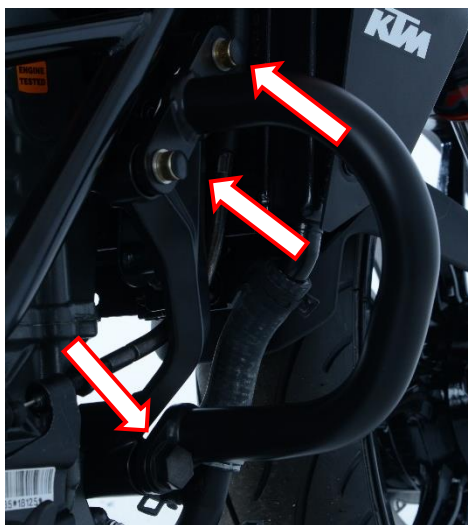

PICTURE 5



FITTING INSTRUCTIONS

- It is a good idea to support the engine at this point to prevent the engine moving to aide assembly.
- From the right hand side of the bike remove the two bolts and lower securing nut arrowed in picture 1
- Remove the lower engine support bolt from the bracket (a soft mallet and drift may be carefully used).
- Insert the two spacers (item 3) into the upper mount tubes and spacer (item 5) into the lower mount tube.
- Carefully offer the right-hand side adventure bar (item 1) into position as shown in picture 2 and secure the two upper mounts in position using both M8 x 45mm bolts with M8 washers (items 6 and 9) ensuring both spacers locate correctly so the adventure bar is loosely fitted to the bike.
- On the left hand side of the bike remove the two bolts arrowed in picture 3.
- Insert the two upper spacers (item 4) into the upper mounting tubes
- Offer up the left hand adventure bar (item 1) to the bike and secure in the same way as the right hand side bar using the two M8 x 40mm (item 7) bolts and washers (item 9) provided. As shown in picture 4
- The lower mounts of both engine bars should now line up with the lower engine mount. Insert the new engine bar (item 8) with washer (item 10) through the plate and spacer from the right hand side into the lower mount and thread into the left hand engine bar boss and tighten to the correct torque
- Tighten the 4 mounting bolts on the left and right hand upper mounts using the correct torque setting.
- Check engine bar is secure and all bolts have been torqued to the correct values
- Finally fit the plastic nut caps (items 11 & 12) onto the mounting bolts on both sides as shown in picture 5.

ISSUE 1 10/09/18 (DM)

CONSUMER NOTICE

The catalogue description and any exhibition of samples are only broad indications of the Products and R&G may make design changes which do not diminish their performance or visual appeal and supplying them in such state shall conform to the order. The Buyer acknowledges no representation or warranty (other than as to title) has been given or will apply to the Products other than those in R&G's order or confirmation and the Buyer confirms it has chosen the Products as being of merchantable quality and suitable for its particular purposes. Where R&G fits the Products or undertakes other services it shall exercise reasonable skill and care and rectify any fault free of charge unless the workmanship has been disturbed. The Buyer is responsible for ensuring that the warranty on the motorcycle is not affected by the fitting of the Products. On return of any defective Products R&G shall at its option either supply a replacement or refund the purchase money but shall not be liable if the Products have been modified or used or maintained otherwise than in accordance with R&G's or manufacturer's instructions and good engineering practice or if the defect arises from accident or neglect. Other than identified above and subject to R&G not limiting its liability for causing death and personal injury, it shall not be liable for indirect or consequential loss and otherwise its liability shall be limited to the amounts paid by the Buyer for the Products or the fitting or service concerned. These terms do not affect the Buyer's statutory rights.

R&G RETURNS POLICY (NON-FAULTY GOODS)

Returns must be pre-authorized (if not pre-authorized the return will be rejected). Goods may only be returned direct to us if they were purchased direct from us (customer must prove if necessary). Otherwise to be returned to original vendor. Goods must be in re-sellable condition, in the opinion of R&G. All returns are subject to a 25% restocking and handling fee (25% of the gross value exc. P&P – at the prevailing price at time of purchase). The customer must pay any and all carriage charges. No returns of discontinued products, unless within 14 days of purchase. This policy does not affect your statutory rights and does not refer to faulty goods.

R&G

Unit 1, Shelley's Lane, East Worldham, Alton, Hampshire, GU34 3AQ

Tel: +44 (0)1420 89007 Fax: +44 (0)1420 87301 www.rg-racing.com Email: info@rg-racing.com



NOTICE DE MONTAGE POUR AB0032BK BARRES AVENTURE
KTM DUKE 125 + 390 2017



Le kit contient les articles exposés ci-dessous, vérifier que toutes les pièces soient présentes avant de procéder au montage.

La façon dont le kit est emballé ne correspond pas forcément à la façon de monter les pièces sur la moto

Notez que si les kits sont emballés avec des rondelles en caoutchouc servant à tenir les composants, *ces rondelles doivent être jetées !*

THE PARTS SHOWN MAY BE REPRESENTATIVE ONLY (FOR CLARITY OF INSTRUCTIONS ONLY)

Notice disponible au téléchargement sur www.rg-racing.com

R&G

Unit 1, Shelley's Lane, East Worldham, Alton, Hampshire, GU34 3AQ

Tel: +44 (0)1420 89007 Fax: +44 (0)1420 87301 www.rg-racing.com Email: info@rg-racing.com



VALEURS DE SERRAGE RECOMMANDEES :

M4 BOULON = 8Nm
M5 BOULON = 12Nm
M6 BOULON = 15Nm
M8 BOULON = 20Nm
M10 BOULON = 40Nm

OUTILS REQUIS

- Jeu de clés et douilles.
- Clé dynamométrique (à 40Nm).
- Maillet à surface plate.

LE KIT INCLUS:

13. 1 x CB066 BARRE DE CRASH CÔTÉ DROIT NOIR
14. 1 x CB065 BARRE DE CRASH CÔTÉ GAUCHE NOIR
15. 2 x S1089 10mm ENTRETOISES NOIR
16. 2 x S1088 12mm ENTRETOISES NOIR
17. 1 x S1090 22mm ENTRETOISE NOIR
18. 2 x M8 x 1.25 x 40mm BOULONS
19. 2 x M8 x 1.25 x 45mm BOULONS
20. 1 x M10 x 1.5 x 160mm BOULONS
21. 4 x M8 RONDELLES
22. 1 x M10 RONDELLES
23. 4 x M8 BOUCHON DE BOULON
24. 1 x M10 CAPUCHON DE BOULON

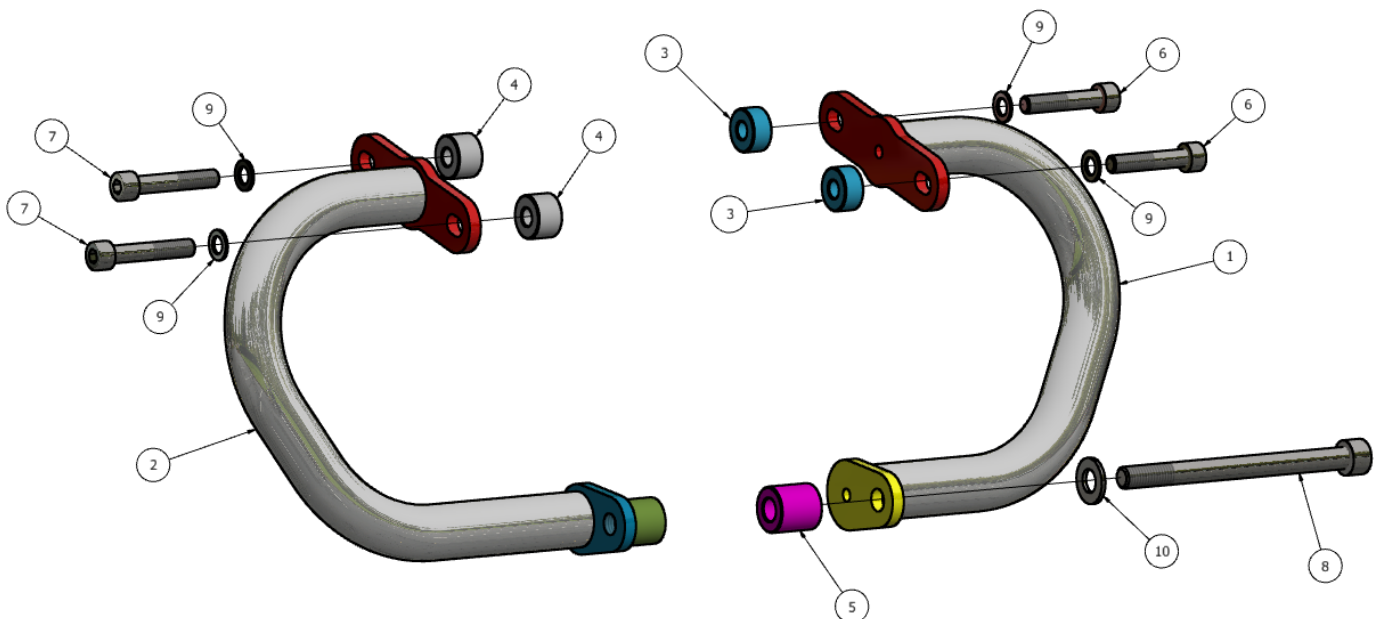

R&G

Unit 1, Shelley's Lane, East Worldham, Alton, Hampshire, GU34 3AQ

Tel: +44 (0)1420 89007 Fax: +44 (0)1420 87301 www.rg-racing.com Email: info@rg-racing.com

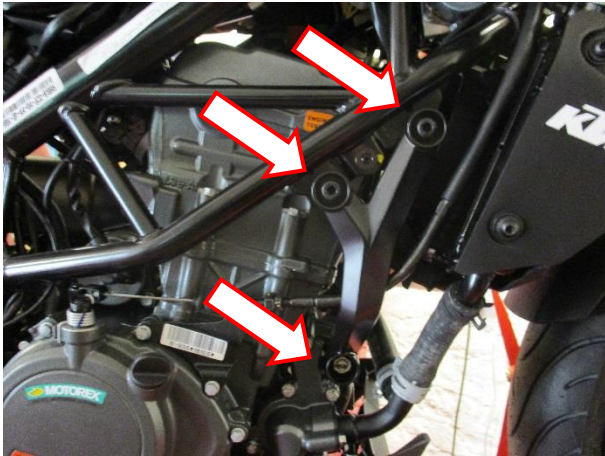

PHOTO 1



PHOTO 2

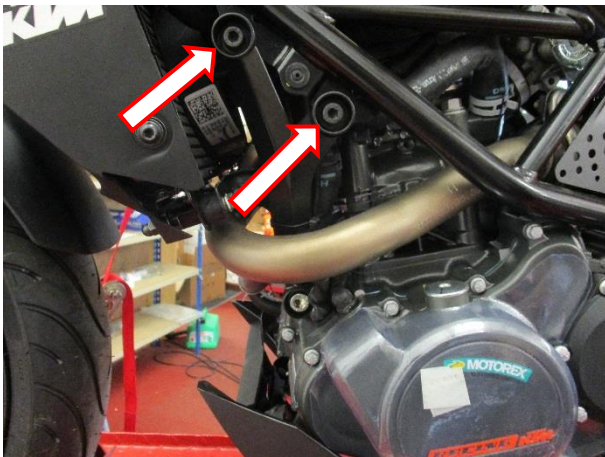

PHOTO 3



PHOTO 4

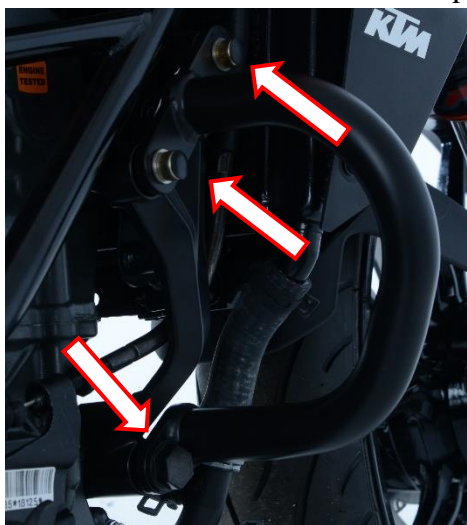

PHOTO 5



NOTICE DE MONTAGE

- Il est judicieux de supporter le moteur pour éviter qu'il bouge et ne complique le montage.
- Du côté droit de la moto, enlever les 2 boulons puis baisser l'écrou de fixation, voir photo 1
- Enlever le boulon de support moteur inférieur de son support (un maillet doux et une dérive peuvent être utilisés, avec précaution).
- Insérer les 2 entretoises (article 3) dans les tubes de support supérieurs et entretoises (article 5) dans le tube de support inférieur.
- Monter la barre aventure du côté droit (article 1) en position, voir photo 2 puis fixer les 2 supports supérieurs en position en utilisant les 2 boulons M8 x 45mm avec rondelles M8 (articles 6 et 9) en veillant à ce que les 2 entretoises se placent correctement de façon à ce que la barre aventure soit montée sur la moto, sans être serrée.
- Du côté gauche de la moto, enlever les 2 boulons indiqués sur la photo 3.
- Insérer les 2 entretoises supérieures (article 4) dans les tubes de fixation supérieurs.
- Monter la barre Aventure du côté gauche (article 1) sur la moto puis la fixer de la même façon que la barre Aventure du côté droit, avec les 2 boulons M8 x 40mm (article 7) et rondelles (article 9) fournis, voir photo 4.
- Les supports inférieurs des 2 barres moteur devraient à présent s'aligner avec le support moteur inférieur. Insérer le nouvel axe moteur (article 8) avec rondelle (article 10) dans la plaque et l'entretoise du côté droit dans le support inférieur, et le filetage dans le trou d'axe moteur du côté gauche puis serrer selon les valeurs recommandées.
- Serrer les 4 boulons de fixation de supports supérieurs des 2 côtés gauche et droit, en utilisant les bonnes valeurs de serrage.
- Vérifier que l'axe moteur soit fixé et que tous les boulons aient été serrés selon les valeurs recommandées.
- Insérer les bouchons d'écrous (articles 11 & 12) sur les boulons de montage des 2 côtés, voir photo 5.

ISSUE 1 10/09/18 (DM)

CONSUMER NOTICE

The catalogue description and any exhibition of samples are only broad indications of the Products and R&G may make design changes which do not diminish their performance or visual appeal and supplying them in such state shall conform to the order. The Buyer acknowledges no representation or warranty (other than as to title) has been given or will apply to the Products other than those in R&G's order or confirmation and the Buyer confirms it has chosen the Products as being of merchantable quality and suitable for its particular purposes. Where R&G fits the Products or undertakes other services it shall exercise reasonable skill and care and rectify any fault free of charge unless the workmanship has been disturbed. The Buyer is responsible for ensuring that the warranty on the motorcycle is not affected by the fitting of the Products. On return of any defective Products R&G shall at its option either supply a replacement or refund the purchase money but shall not be liable if the Products have been modified or used or maintained otherwise than in accordance with R&G's or manufacturer's instructions and good engineering practice or if the defect arises from accident or neglect. Other than identified above and subject to R&G not limiting its liability for causing death and personal injury, it shall not be liable for indirect or consequential loss and otherwise its liability shall be limited to the amounts paid by the Buyer for the Products or the fitting or service concerned. These terms do not affect the Buyer's statutory rights.

R&G RETURNS POLICY (NON-FAULTY GOODS)

Returns must be pre-authorized (if not pre-authorized the return will be rejected). Goods may only be returned direct to us if they were purchased direct from us (customer must prove if necessary). Otherwise to be returned to original vendor. Goods must be in re-sellable condition, in the opinion of R&G. All returns are subject to a 25% restocking and handling fee (25% of the gross value exc. P&P – at the prevailing price at time of purchase). The customer must pay any and all carriage charges. No returns of discontinued products, unless within 14 days of purchase. This policy does not affect your statutory rights and does not refer to faulty goods.

R&G

Unit 1, Shelley's Lane, East Worldham, Alton, Hampshire, GU34 3AQ

Tel: +44 (0)1420 89007 Fax: +44 (0)1420 87301 www.rg-racing.com Email: info@rg-racing.com



MONTAGEANLEITUNG FÜR AB0032BK ADVENTURE STURZBÜGEL
KTM DUKE 125 + 390 2017



ALLE TEILE SIND UNTEN ABGEBILDET UND GEKENNZEICHNET. BEVOR SIE MIT DER MONTAGE BEGINNEN, ÜBERPRÜFEN SIE, DASS ALLE TEILE VORHANDEN SIND.

Hinweis: Die Verpackung der Teile stellt nicht die Reihenfolge der Montage dar.

Hinweis für Kits mit Plastikunterlegscheiben an den Schrauben – *Diese Plastikunterlegscheiben werden nicht für den Einbau benötigt!*

DIE UNTEN ABGEBILDETEN TEILE DIENEN LEDIGLICH ZUR ERKLÄRUNG

Eine digitale Version dieser Montageanleitung kann auf folgender Seite heruntergeladen werden:

www.rg-racing.com

R&G

Unit 1, Shelley's Lane, East Worldham, Alton, Hampshire, GU34 3AQ
Tel: +44 (0)1420 89007 Fax: +44 (0)1420 87301 www.rg-racing.com Email: info@rg-racing.com



ALLGEMEINE ANZUGSDREHMOMENTE:

- M4 SCHRAUBE = 8Nm
- M5 SCHRAUBE = 12Nm
- M6 SCHRAUBE = 15Nm
- M8 SCHRAUBE = 20Nm
- M10 SCHRAUBE = 40Nm

SIE BENÖTIGEN FOLGENDES WERZEUG

- Steckschlüsselsatz
- Drehmomentschlüssel (bis 40Nm)
- Schonhammer

LIEFERUMFANG

1. 1 x CB066 STURZBÜGEL RECHTS SCHWARZ
2. 1 x CB065 STURZBÜGEL LINKS SCHWARZ
3. 2 x S1089 10mm DISTANZHALTER SCHWARZ
4. 2 x S1088 12mm DISTANZHALTER SCHWARZ
5. 1 x S1090 22mm DISTANZHALTER SCHWARZ
6. 2 x M8 x 1,25 x 40mm INBUSSCHRAUBE
7. 2 x M8 x 1,25 x 45mm INBUSSCHRAUBE
8. 1 x M10 x 1,5 x 160mm SECHSKANTSCHRAUBE
9. 4 x M8 UNTERLEGSSCHEIBE
10. 1 x M10 UNTERLEGSSCHEIBE
11. 4 x KAPPE FÜR M8 INBUSSCHRAUBE
12. 1 x KAPPE FÜR M10 SCHRAUBE

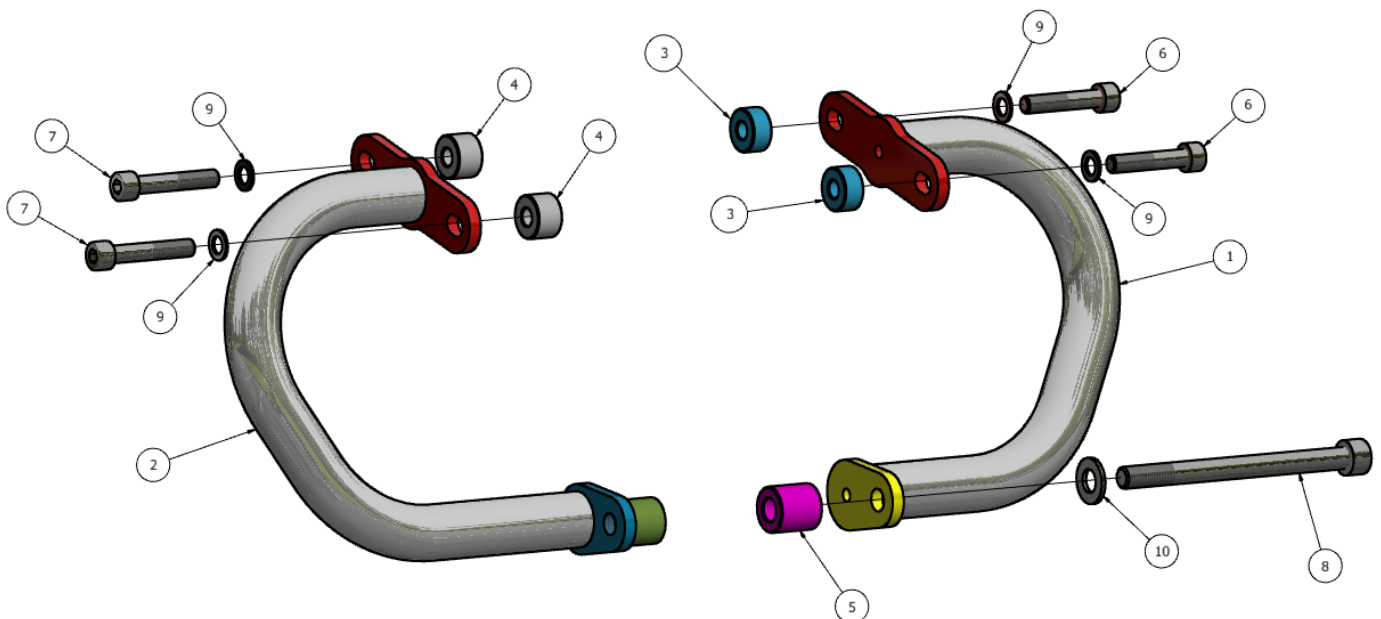

R&G

Unit 1, Shelley's Lane, East Worldham, Alton, Hampshire, GU34 3AQ

Tel: +44 (0)1420 89007 Fax: +44 (0)1420 87301 www.rg-racing.com Email: info@rg-racing.com



ABBILDUNG 1



ABBILDUNG 2

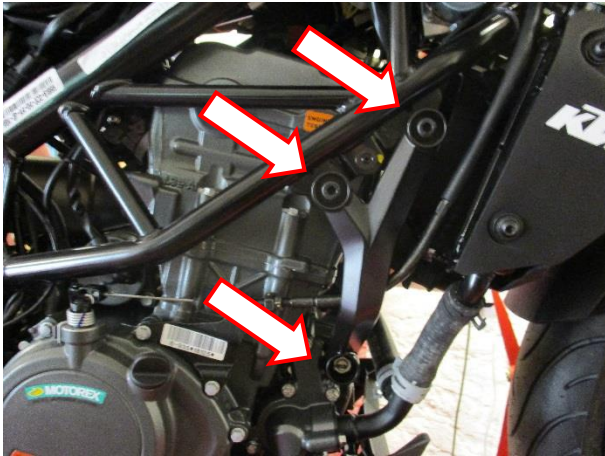

ABBILDUNG 3



ABBILDUNG 4

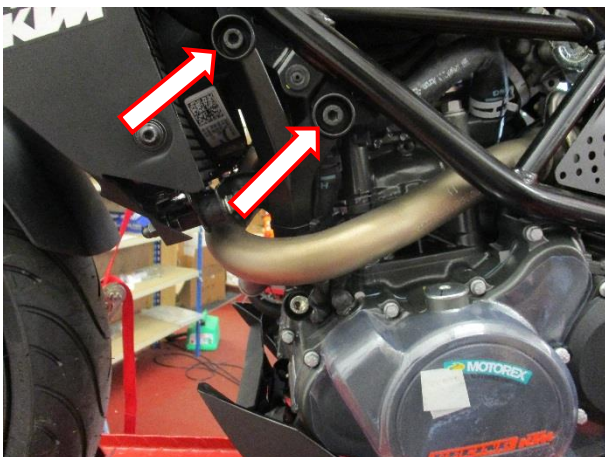

ABBILDUNG 5



MONTAGEANLEITUNG

- Es empfiehlt sich, den Motor zu stützen - somit wird verhindert, dass der Motor sich während der Montage bewegen kann.
- Entfernen Sie die zwei Schrauben an der rechten Seite des Motorrades sowie die untere Mutter, die in Abbildung 1 gekennzeichnet ist.
- Entfernen Sie die untere Befestigungsschraube von der Halterung (eventuell hierbei einen Schonhammer benutzen).
- Die zwei Distanzhalter (Artikel 3) in die oberen Montageröhren einsetzen sowie den Distanzhalter (Artikel 5) in die untere Montageröhre.
- Den Adventure Sturzbügel für die rechte Seite (Artikel 1) in Position bringen wie in Abbildung 2 abgebildet und die zwei oberen Halterungen mit den zwei M8 x 45mm Schrauben und M8 Unterlegscheiben (Artikel 6 und 9) befestigen. Bitte darauf achten, dass beide Distanzhalter richtig montiert sind, so dass der Adventure Sturzbügel lose am Motorrad fixiert ist.
- Entfernen Sie die zwei Schrauben an der linken Seite des Motorrades, die in Abbildung 3 gekennzeichnet sind.
- Die zwei oberen Distanzhalter (Artikel 4) in die oberen Montageröhren einsetzen.
- Den Adventure Sturzbügel für die linke Seite (Artikel 2) auf gleiche Weise wie zuvor an der rechten Seite anbringen und mit den zwei M8 x 40mm Schrauben (Artikel 7) und Unterlegscheiben (Artikel 9) befestigen – siehe Abbildung 4.
- Die unteren Halterungen von beiden Verbindungsstangen sollten jetzt mit der unteren Motorhalterung ausgerichtet sein. Die neue Verbindungsschraube (Artikel 8), die mit einer Unterlegscheibe (Artikel 10) versehen ist, von der rechten Seite beginnend durch die Platte und den Distanzhalter in die untere Halterung einführen und mit dem richtigen Drehmoment im Gewindeinsatz an der linken Seite festziehen.
- Ziehen Sie die 4 Montageschrauben an der linken und rechten oberen Halterung mit dem richtigen Anzugsdrehmoment fest.
- Überprüfen Sie, dass die Verbindungsschraube sicher ist, und dass alle Schrauben mit dem richtigen Anzugsdrehmoment festgezogen wurden.
- Montieren Sie die Plastikkappen (Artikel 11 & 12) an den Schrauben an beiden Seiten des Motorrades wie in Abbildung 5 abgebildet.

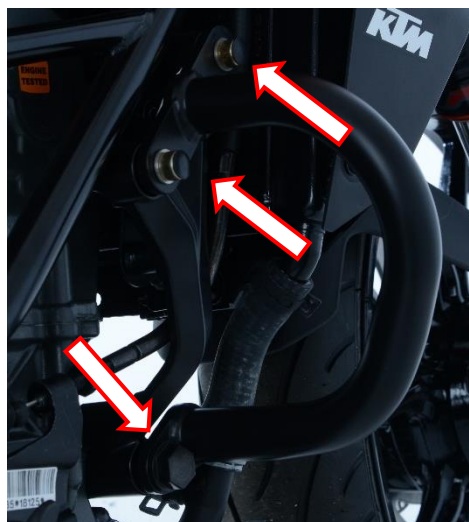
AUSGABE 1 10/09/18 (DM)

CONSUMER NOTICE

The catalogue description and any exhibition of samples are only broad indications of the Products and R&G may make design changes which do not diminish their performance or visual appeal and supplying them in such state shall conform to the order. The Buyer acknowledges no representation or warranty (other than as to title) has been given or will apply to the Products other than those in R&G's order or confirmation and the Buyer confirms it has chosen the Products as being of merchantable quality and suitable for its particular purposes. Where R&G fits the Products or undertakes other services it shall exercise reasonable skill and care and rectify any fault free of charge unless the workmanship has been disturbed. The Buyer is responsible for ensuring that the warranty on the motorcycle is not affected by the fitting of the Products. On return of any defective Products R&G shall at its option either supply a replacement or refund the purchase money but shall not be liable if the Products have been modified or used or maintained otherwise than in accordance with R&G's or manufacturer's instructions and good engineering practice or if the defect arises from accident or neglect. Other than identified above and subject to R&G not limiting its liability for causing death and personal injury, it shall not be liable for indirect or consequential loss and otherwise its liability shall be limited to the amounts paid by the Buyer for the Products or the fitting or service concerned. These terms do not affect the Buyer's statutory rights.

R&G RETURNS POLICY (NON-FAULTY GOODS)

Returns must be pre-authorized (if not pre-authorized the return will be rejected). Goods may only be returned direct to us if they were purchased direct from us (customer must prove if necessary). Otherwise to be returned to original vendor. Goods must be in re-sellable condition, in the opinion of R&G. All returns are subject to a 25% restocking and handling fee (25% of the gross value exc. P&P – at the prevailing price at time of purchase). The customer must pay any and all carriage charges. No returns of discontinued products, unless within 14 days of purchase. This policy does not affect your statutory rights and does not refer to faulty goods.

R&G

Unit 1, Shelley's Lane, East Worldham, Alton, Hampshire, GU34 3AQ

Tel: +44 (0)1420 89007 Fax: +44 (0)1420 87301 www.rg-racing.com Email: info@rg-racing.com