



MODEL KAWASAKI NINJA 300
KAWASAKI Z 300
LINE SPORT

YEAR 2013-
2015-
MUFFLER SUONO

SCHEMATIC

ELENCO PARTI / PARTS LIST

| # | QTÀ / QTY | DESCRIZIONE / DESCRIPTION | CODICE / CODE |
|----|-----------|---|---------------|
| 1 | 1 | DB killer / DB killer | 50.DK.072.0 |
| 2 | 1 | Vite M5x12 / Screw M5 x 12 | 50.73.628.1 |
| 3 | 1 | Tappo in gomma / Rubber stopper | 50.73.266.1 |
| 4 | 1 | Silenziatore / Muffler | SUONO 270 |
| 5 | 2 | Tassello grande / Rubber big block | 50.73.203.1 |
| 6 | 1 | Staffa in carbonio / Carbon fiber bracket | 50.SS.193.1 |
| 7 | 1 | Dado M8 flangiato / Flanged nut M8 | 50.73.393.1 |
| 8 | 1 | Rondella in alluminio / Aluminium washer | 50.73.248.1 |
| 9 | 1 | Vite M8x25 / Screw M8x25 | 50.73.064.1 |
| 10 | 1 | Staffa / Braket | 50.SS.901.0 |
| 11 | 1 | Dado 10 MA flangiato / Flanged nut 10 MA | 50.73.332.1 |
| 12 | 1 | Rondella in alluminio nera / Black aluminium washer | 50.73.330.1 |
| 13 | 1 | Vite M10x60 / Screw M10x60 | 50.73.135.1 |
| 14 | 1 | Db Killer forato / Drilled DB killer | 50.DK.082.0 |
| 15 | 1 | Boccola / Bush | 50.73.691.1 |
| 16 | 1 | Tubo di raccordo / Link pipe | 9773K038S2 |
| 17 | 1 | Fascetta Ø 37/40 mm / Pipe clamp Ø 37/40 mm | 50.FA.003.1 |
| 18 | 1 | Molla corta / Short Spring | 50.73.123.1 |
| 19 | 1 | Tubo in gomma per molla / Rubber pipe for spring | 50.73.210.1 |

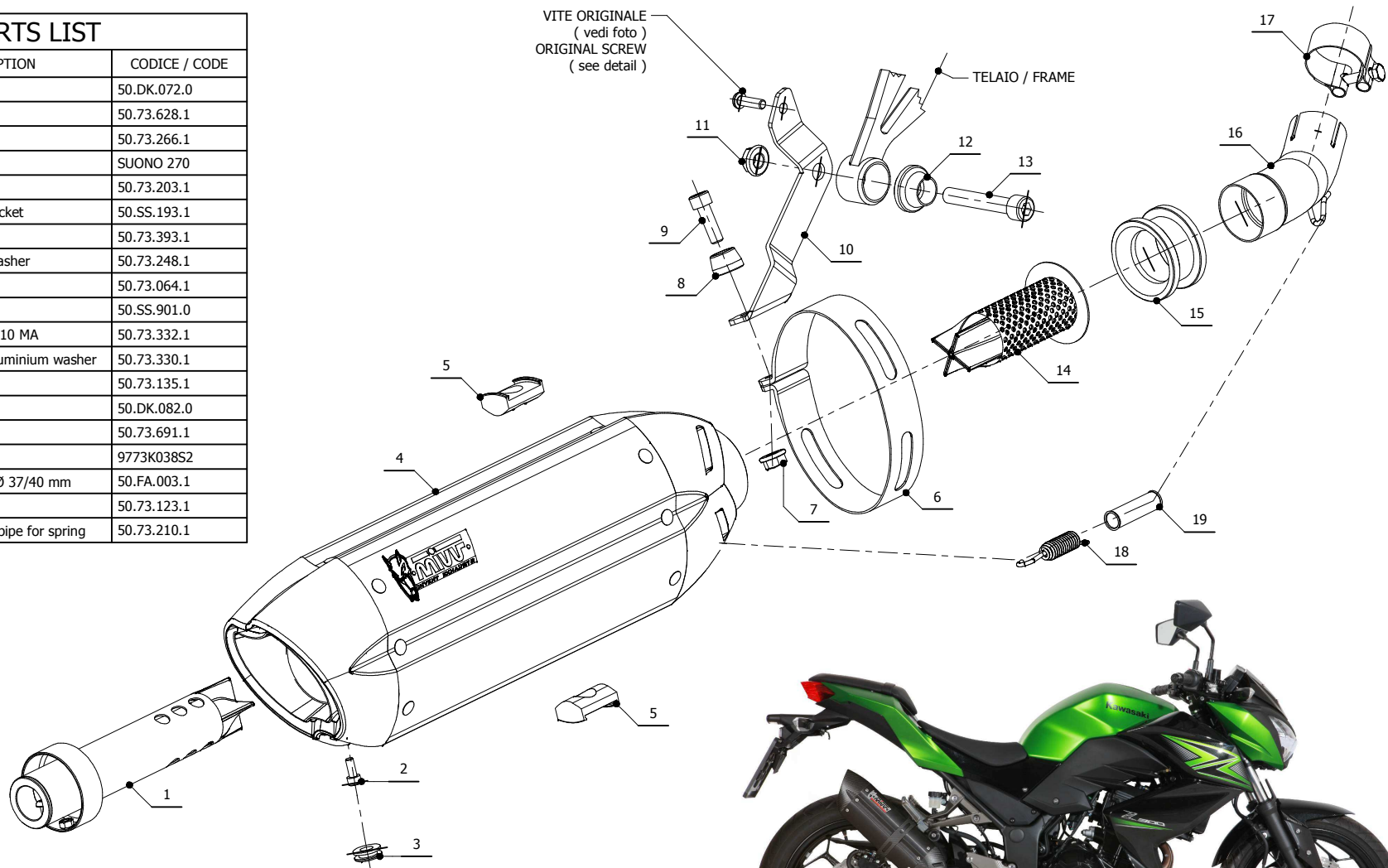

APPLICAZIONI / APPLICATIONS

| CODICE / CODE | TUBO / PIPE | SILENZIATORE / MUFFLER | FASCETTA / CLAMP | CODICE OMOL. / HOMOL. CODE |
|---------------|------------------|---|-------------------------|----------------------------|
| K.038.L7 | INOX / ST. STEEL | INOX (COPPE CARBONIO) / ST. STEEL (CARBON CAPS) | CARBONIO / CARBON FIBER | ME046 e9 1352 |
| K.038.L9 | INOX / ST. STEEL | STEEL BLACK | CARBONIO / CARBON FIBER | ME046 e9 1352 |